

Volume 216 • 2018

ISSN 1877-7058

Procedia Engineering



ICMAT 2017 Symposium (M to Z)

Guest Editors:

Jun Ding

Santiranjana Shannigrahi

Mohit Sharma

Available online at www.sciencedirect.com

ScienceDirect

ICSDEC 2016 – Integrating Data Science, Construction and Sustainability

Edited

by Oswald Chong, Kristen Parrish, Pingbo Tang, David Grau, Jae Chang

Volume 145,

Pages 1-1594 (2016)

1. EditorialOpen access

Preface

Pages 1-10

[Download PDF](#)

2. select article Waging War on Climate Change: Mapping Energy Policies to Their Strategic, Tactical, and Operational Levels

Research articleOpen access

Waging War on Climate Change: Mapping Energy Policies to Their Strategic, Tactical, and Operational Levels

R. Arababadi, K. Parrish, M. El Asmar

Pages 11-17

[Download PDF](#)

Article preview

3. select article Applicability of Radiant Heating-Cooling Ceiling Panels in Residential Buildings in Different Climates of Iran

Research articleOpen access

Applicability of Radiant Heating-Cooling Ceiling Panels in Residential Buildings in Different Climates of Iran

S. Moslehi, M. Maerefat, R. Arababadi

Pages 18-25

[Download PDF](#)

Article preview

4. select article Thermally Adaptive Building Covering Field Test

Research articleOpen access

Thermally Adaptive Building Covering Field Test
Ronald M. Barrett, Ronald P. Barrett

Pages 26-33

[Download PDF](#)

Article preview

5. select article A Simulation Framework for Sustainability Assessment in Evolving Socio-Technical Infrastructure Systems

Research articleOpen access

A Simulation Framework for Sustainability Assessment in Evolving Socio-Technical Infrastructure Systems
Mostafa Batouli, Ali Mostafavi

Pages 34-41

[Download PDF](#)

Article preview

6. select article Modeling Occupant-Building-Appliance Interaction for Energy Waste Analysis

Research articleOpen access

Modeling Occupant-Building-Appliance Interaction for Energy Waste Analysis
Triana Carmenate, Peeraya Inyim, Nupoor Pachekar, Geeticka Chauhan, ... Ali Mostafavi

Pages 42-49

[Download PDF](#)

Article preview

7. select article Service Learning for Sustainability: A Tale of Two Projects

Research articleOpen access

Service Learning for Sustainability: A Tale of Two Projects
Annie Pearce, William Manion

Pages 50-57

[Download PDF](#)

Article preview

8. select article Investigating the Effect of Environmental Product Declaration Adoption in LEED® on the Construction Industry: A Case Study

Research articleOpen access

Investigating the Effect of Environmental Product Declaration Adoption in LEED® on the Construction Industry: A Case Study
M.D.C. Gelowitz, J.J. McArthur

Pages 58-65

[Download PDF](#)

Article preview

9. select article Optimization of Gradation and Fineness Modulus of Naturally Fine Sands for Improved Performance as Fine Aggregate in Concrete

Research articleOpen access

Optimization of Gradation and Fineness Modulus of Naturally Fine Sands for Improved Performance as Fine Aggregate in Concrete
Gauhar Sabih, Rafiqul A. Tarefder, Syed M. Jamil

Pages 66-73

[Download PDF](#)

Article preview

10. select article Cost Comparative Analysis to Evaluate Wastewater Service Charge Savings Strategies

Research articleOpen access

Cost Comparative Analysis to Evaluate Wastewater Service Charge Savings Strategies

Wei T. Li, Joseph J. Kim, Jin Gi Hong

Pages 74-81

[Download PDF](#)

Article preview

11. select article Dynamic Management of Cost Contingency: Impact of KPIs and Risk Perception

Research articleOpen access

Dynamic Management of Cost Contingency: Impact of KPIs and Risk Perception

Bilal Ayub, Muhammad Jamaluddin Thaheem, Zia ud Din

Pages 82-87

[Download PDF](#)

Article preview

12. select article Buildings and Their Integration in Communities: Case Study of a Parking Plaza

Research articleOpen access

Buildings and Their Integration in Communities: Case Study of a Parking Plaza

Tayyab Ahmad, Muhammad Jamaluddin Thaheem, Amad Anwar, Zia ud Din

Pages 88-95

[Download PDF](#)

Article preview

13. select article Implications of Stereotype Mosque Architecture on Sustainability

Research articleOpen access

Implications of Stereotype Mosque Architecture on Sustainability
Tayyab Ahmad, Muhammad Jamaluddin Thaheem, Amad Anwar, Zia ud Din

Pages 96-103

[Download PDF](#)

Article preview

14. select article Performance of Ternary Binder Blend Containing Cement, Waste Gypsum Wall Boards and Blast Furnace Slag in CLSM

Research articleOpen access

Performance of Ternary Binder Blend Containing Cement, Waste Gypsum Wall Boards and Blast Furnace Slag in CLSM
T. Raghavendra, Y.H. Siddanagouda, Fayaz Jawad, C.Y. Adarsha, B.C. Udayashankar

Pages 104-111

[Download PDF](#)

Article preview

15. select article Stepwise Application of BIM-based Parametric Modeling to Tapered Slip-Form System

Research articleOpen access

Stepwise Application of BIM-based Parametric Modeling to Tapered Slip-Form System

BongYoung Yoo, HyeJin Yoon, YoungJin Kim, Kwang Myong Lee

Pages 112-119

[Download PDF](#)

Article preview

16. select article A Multiuser Shared Virtual Environment for Facility Management

Research articleOpen access

A Multiuser Shared Virtual Environment for Facility Management
Yangming Shi, Jing Du, Sarel Lavy, Dong Zhao

Pages 120-127

[Download PDF](#)

Article preview

17. select article A Contingency Cost Estimation System for Road Maintenance Contracts

Research articleOpen access

A Contingency Cost Estimation System for Road Maintenance Contracts
Kabindra K. Shrestha, Pramen P. Shrestha

Pages 128-135

[Download PDF](#)

Article preview

18. select article A Nearshore Heaving-Buoy Sea Wave Energy Converter for Power Production

Research articleOpen access

A Nearshore Heaving-Buoy Sea Wave Energy Converter for Power Production

Joseph Youssef, Jean Matar, Pierre Rahme, Charbel Bou-Mosleh

Pages 136-143

[Download PDF](#)

Article preview

19. select article Wave Roller Device for Power Generation

Research articleOpen access

Wave Roller Device for Power Generation

Wassim Chehaze, Dory Chamoun, Charbel Bou-Mosleh, Pierre Rahme

Pages 144-150

[Download PDF](#)

Article preview

20. select article Integration of BIM in Construction Management Education: An Overview of Pakistani Engineering Universities

Research articleOpen access

Integration of BIM in Construction Management Education: An Overview of Pakistani Engineering Universities

Ali Abbas, Zia Ud Din, Rizwan Farooqui

Pages 151-157

[Download PDF](#)

Article preview

21. select article Integrating Research Findings into Sustainable Building Delivery Teaching

Research articleOpen access

Integrating Research Findings into Sustainable Building Delivery Teaching

Suat Gunhan

Pages 158-163

[Download PDF](#)

Article preview

22. select article Novel Integration of Sustainable and Construction Decisions into the Design Bid Build Project Delivery Method Using BPMN

Research articleOpen access

Novel Integration of Sustainable and Construction Decisions into the Design Bid Build Project Delivery Method Using BPMN

Ahmed K. Ali, Ralph Badinelli

Pages 164-171

[Download PDF](#)

Article preview

23. select article Low-Investment Energy Retrofit Framework for Small and Medium Office Buildings

Research articleOpen access

Low-Investment Energy Retrofit Framework for Small and Medium Office Buildings

Fernanda Cruz Rios, Kristen Parrish, Wai K. Chong

Pages 172-179

[Download PDF](#)

Article preview

24. select article A Proposal for Green Financing as a Mechanism to Increase Private Participation in Sustainable Water Infrastructure Systems: The Colombian Case

Research articleOpen access

A Proposal for Green Financing as a Mechanism to Increase Private Participation in Sustainable Water Infrastructure Systems: The Colombian Case

J.D. González Ruiz, C.A. Arboleda, S. Botero

Pages 180-187

[Download PDF](#)

[Article preview](#)

25. select article Research on A New Technology Integrated Low-cost, Near-zero-energy Solar Greenhouse

Research articleOpen access

Research on A New Technology Integrated Low-cost, Near-zero-energy Solar Greenhouse

Shijun Sun, Changhong Zhan, Gang Yang, Yan'guo Yu

Pages 188-195

[Download PDF](#)

[Article preview](#)

26. select article Expression and Evidence, Advances in Architecture Studio Pedagogy

Research articleOpen access

Expression and Evidence, Advances in Architecture Studio Pedagogy

Keelan P. Kaiser, David M. Ogoli

Pages 196-202

[Download PDF](#)

[Article preview](#)

27. select article Analysis of Credits Earned by LEED Healthcare Certified Facilities

Research articleOpen access

Analysis of Credits Earned by LEED Healthcare Certified Facilities
Maryam Golbazi, Can B. Aktas

Pages 203-210

[Download PDF](#)

[Article preview](#)

28. select article Investigating Building Construction Process and Developing a Performance Index

Research articleOpen access

Investigating Building Construction Process and Developing a Performance Index

Mohamed ELZomor, Kristen Parrish

Pages 211-218

[Download PDF](#)

[Article preview](#)

29. select article Risks Involved in Using Alternative Project Delivery (APD) Methods in Water and Wastewater Projects

Research articleOpen access

Risks Involved in Using Alternative Project Delivery (APD) Methods in Water and Wastewater Projects

Pramen P. Shrestha, Jacimaria Batista, Ruiko Maharjan

Pages 219-223

[Download PDF](#)

[Article preview](#)

30. select article Developing Sustainable Infrastructure for Small Hydro Power Plants through Clean Development Mechanisms in Colombia

Research articleOpen access

Developing Sustainable Infrastructure for Small Hydro Power Plants through Clean Development Mechanisms in Colombia

E.A. Duque, J.D. González, J.C. Restrepo

Pages 224-233

[Download PDF](#)

[Article preview](#)

31. select article Development of Social Responsibility Evaluation Framework of Construction Projects: A Multi-stakeholders Perspective

Research articleOpen access

Development of Social Responsibility Evaluation Framework of Construction Projects: A Multi-stakeholders Perspective

Pin-Chao Liao, Ganbat Tsenguun, Lore Wenhui Liang

Pages 234-241

[Download PDF](#)

[Article preview](#)

32. select article Environmental Practices in Construction Firms

Research articleOpen access

Environmental Practices in Construction Firms

Nor'Aini Yusof, Nazirah Zainul Abidin, Mohammad Iranmanesh

Pages 242-249

[Download PDF](#)

[Article preview](#)

33. select article Physical and Mechanical Properties of Cement Mortar Containing Fine Sand Contaminated with Light Crude Oil

Research articleOpen access

Physical and Mechanical Properties of Cement Mortar Containing Fine Sand Contaminated with Light Crude Oil

Rajab M. Abousnina, Allan Manalo, Weena Lokuge

Pages 250-258

[Download PDF](#)

Article preview

34. select article Optimizing BIM Metadata Manipulation Using Parametric Tools

Research articleOpen access

Optimizing BIM Metadata Manipulation Using Parametric Tools

M. Khaja, J.D. Seo, J.J. McArthur

Pages 259-266

[Download PDF](#)

Article preview

35. select article Application of Clonal Selection Algorithm in Construction Site Utilization Planning Optimization

Research articleOpen access

Application of Clonal Selection Algorithm in Construction Site Utilization Planning Optimization

Xi Wang, Abhijeet S. Deshpande, Gabriel B. Dadi, Baris Salman

Pages 267-273

[Download PDF](#)

Article preview

36. select article Modeling BMP and Vegetative Cover Performance for Highway Stormwater Runoff Reduction

Research articleOpen access

Modeling BMP and Vegetative Cover Performance for Highway Stormwater Runoff Reduction

Azadeh Akhavan Bloorchian, Laurent Ahiablame, Abdolreza Osouli, Jianpeng Zhou

Pages 274-280

[Download PDF](#)

[Article preview](#)

37. select article Analysis of Workflow Variability's Impacts on Trade and Project Performance

Research articleOpen access

Analysis of Workflow Variability's Impacts on Trade and Project Performance
Ashtad Javanmardi, S. Alireza Abbasian-Hosseini, Min Liu,
Simon M. Hsiang

Pages 281-287

[Download PDF](#)

[Article preview](#)

38. select article Improving Socially Sustainable Design and Construction in Developing Countries

Research articleOpen access

Improving Socially Sustainable Design and Construction in Developing Countries

James Pocock, Carey Steckler, Barbora Hanzalova

Pages 288-295

[Download PDF](#)

[Article preview](#)

39. select article A Simulation-based Evaluation of Connected Vehicle Technology for Emissions and Fuel Consumption

Research articleOpen access

A Simulation-based Evaluation of Connected Vehicle Technology for Emissions and Fuel Consumption

Shailesh Chandra, Francisco Camal

Pages 296-303

[Download PDF](#)

[Article preview](#)

40. select article A Multi-modal Transportation Score to Evaluate Infrastructure Supply-demand for Commuters

Research articleOpen access

A Multi-modal Transportation Score to Evaluate Infrastructure Supply-demand for Commuters

Shailesh Chandra, Malcolm Braughton, Luis David Galicia, Alfredo Sanchez, ... Rafael Aldrete

Pages 304-311

[Download PDF](#)

[Article preview](#)

41. select article Optimization of Polymer-Amended Fly Ash and Paper Pulp Millings Mixture for Alternative Landfill Liner

Research articleOpen access

Optimization of Polymer-Amended Fly Ash and Paper Pulp Millings Mixture for Alternative Landfill Liner

Gerjen I. Slim, Matthew Morales, Lamyaa Alrumaidhin, Patrick Bridgman, ... Wilbert I. Odem

Pages 312-318

[Download PDF](#)

[Article preview](#)

42. select article Valuing Energy Performance in Home Purchasing: An Analysis of Mortgage Lending for Sustainable Buildings

Research articleOpen access

Valuing Energy Performance in Home Purchasing: An Analysis of Mortgage Lending for Sustainable Buildings

Ian Hamilton, Gesche Huebner, Richard Griffiths

Pages 319-326

[Download PDF](#)

[Article preview](#)

43. select article Sustainable Temporary Housing: Global Trends and Outlook

Research articleOpen access

Sustainable Temporary Housing: Global Trends and Outlook

Daniel V. Perrucci, Bianca A. Vazquez, Can B. Aktas

Pages 327-332

[Download PDF](#)

[Article preview](#)

44. select article Assessment of the Gains and Benefits of Green Roofs in Different Climates

Research articleOpen access

Assessment of the Gains and Benefits of Green Roofs in Different Climates

Mary Semaan, Annie Pearce

Pages 333-339

[Download PDF](#)

[Article preview](#)

45. select article Resiliency Planning: Prioritizing the Vulnerability of Coastal Bridges to Flooding and Scour

Research articleOpen access

Resiliency Planning: Prioritizing the Vulnerability of Coastal Bridges to Flooding and Scour

Gerarda M. Shields

Pages 340-347

[Download PDF](#)

[Article preview](#)

46. select article Locally Available Geotextile for Maintaining Unpaved Roads in Developing Countries to Enhance Community Resilience

Research articleOpen access

Locally Available Geotextile for Maintaining Unpaved Roads in Developing Countries to Enhance Community Resilience

Yoshinori Fukubayashi, Yuma Daito, Makoto Kimura

Pages 348-355

[Download PDF](#)

[Article preview](#)

47. select article Resilience of Rail Infrastructure in the U.S. Northeast Corridor

Research articleOpen access

Resilience of Rail Infrastructure in the U.S. Northeast Corridor

Daniel Delgado, Can B. Aktas

Pages 356-363

[Download PDF](#)

[Article preview](#)

48. select article The Technology Transfer Systems in Communities, Product Versus Processes

Research articleOpen access

The Technology Transfer Systems in Communities, Product Versus Processes

Villacís Enrique, Rodriguez Lorena, Ayarza Cynthia

Pages 364-371

[Download PDF](#)

Article preview

49. select article Minority Voice in Community Design Building Processes

Research articleOpen access

Minority Voice in Community Design Building Processes

Villacis Enrique, Rodriguez Lorena, Ayarza Cynthia

Pages 372-379

[Download PDF](#)

Article preview

50. select article Assessing the Resilience of LEED Certified Green Buildings

Research articleOpen access

Assessing the Resilience of LEED Certified Green Buildings

Cassandra L. Champagne, Can B. Aktas

Pages 380-387

[Download PDF](#)

Article preview

51. select article Impact of Delay and Escalation on Cash Flow and Profitability in a Real Estate Project

Research articleOpen access

Impact of Delay and Escalation on Cash Flow and Profitability in a Real Estate Project

K. Chandrashekhar Iyer, Ratnesh Kumar

Pages 388-395

[Download PDF](#)

[Article preview](#)

52. select article An Internet-of-Things (IoT) System Development and Implementation for Bathroom Safety Enhancement

Research articleOpen access

An Internet-of-Things (IoT) System Development and Implementation for Bathroom Safety Enhancement

Dan D. Koo, John J. Lee, Aleksei Sebastiani, Jonghoon Kim

Pages 396-403

[Download PDF](#)

[Article preview](#)

53. select article Cost-effectiveness of Rubber and Polymer Modified Asphalt Mixtures as Related to Sustainable Fatigue Performance

Research articleOpen access

Cost-effectiveness of Rubber and Polymer Modified Asphalt Mixtures as Related to Sustainable Fatigue Performance

Mena I. Souliman, Michael Mamlouk, Annie Eifert

Pages 404-411

[Download PDF](#)

Article preview

54. select article Do Sustainable Buildings Inspire More Sustainable Buildings?

Research articleOpen access

Do Sustainable Buildings Inspire More Sustainable Buildings?
Tripp Shealy

Pages 412-419

[Download PDF](#)

Article preview

55. select article Enabling Adaptable Buildings: Results of a Preliminary Expert Survey

Research articleOpen access

Enabling Adaptable Buildings: Results of a Preliminary Expert Survey
Brandon E. Ross, Diana A. Chen, Sheila Conejos, Amin Khademi

Pages 420-427

[Download PDF](#)

Article preview

56. select article Unsupervised Feature Learning for Objects of Interest Detection in Cluttered Construction Roof Site Images

Research articleOpen access

Unsupervised Feature Learning for Objects of Interest Detection in Cluttered Construction Roof Site Images

Madhuri Siddula, Fei Dai, Yanfang Ye, Jianping Fan

Pages 428-435

[Download PDF](#)

Article preview

57. select article Ecosystem Visualization and Analysis of Chinese Prefabricated Housing Industry

Research articleOpen access

Ecosystem Visualization and Analysis of Chinese Prefabricated Housing Industry

Rui Jiang, Chengke Wu, Chao Mao, Asheem Shrestha

Pages 436-443

[Download PDF](#)

Article preview

58. select article Identifying Cost Centers and Environmental Impacts Needs Assessment for Fracking Life Cycle in the United States

Research articleOpen access

Identifying Cost Centers and Environmental Impacts Needs Assessment for Fracking Life Cycle in the United States

Mohammed S. Hashem M. Mehany

Pages 444-451

[Download PDF](#)

Article preview

59. select article A Service Life Analysis of Roundabouts Retrofits for Signalized Intersections

Research articleOpen access

A Service Life Analysis of Roundabouts Retrofits for Signalized Intersections
Xinyi Yang, Mark J. Magalotti

Pages 452-459

[Download PDF](#)

Article preview

60. select article Prospects for Meeting the Corporate Average Fuel Economy Standards in the U.S.

Research articleOpen access

Prospects for Meeting the Corporate Average Fuel Economy Standards in the U.S.

Jessica Zielinski, Rebecca Andreucci, Can B. Aktas

Pages 460-467

[Download PDF](#)

Article preview

61. select article Evaluation of a Holistic Energy Assessment Program

Research articleOpen access

Evaluation of a Holistic Energy Assessment Program

Kevin Ketchman, Vikas Khanna, David Riley, Melissa Bilec

Pages 468-475

[Download PDF](#)

Article preview

62. select article Identifying and Measuring Project Complexity

Research articleOpen access

Identifying and Measuring Project Complexity

Bac Dao, Sharareh Kermanshachi, Jennifer Shane, Stuart Anderson, Eric Hare

Pages 476-482

[Download PDF](#)

Article preview

63. select article Sustainability Evaluation of Pipe Asset Management Strategies

Research articleOpen access

Sustainability Evaluation of Pipe Asset Management Strategies
John C. Matthews, Kalyan Piratla, Dan D. Koo

Pages 483-490

[Download PDF](#)

[Article preview](#)

64. select article Project Complexity Assessment and Management Tool

Research articleOpen access

Project Complexity Assessment and Management Tool
Bac Dao, Sharareh Kermanshachi, Jennifer Shane, Stuart Anderson

Pages 491-496

[Download PDF](#)

[Article preview](#)

65. select article Mathematically Characterizing Natural Systems for Adaptable, Biomimetic Design

Research articleOpen access

Mathematically Characterizing Natural Systems for Adaptable, Biomimetic Design

Diana A. Chen, Leidy E. Klotz, Brandon E. Ross

Pages 497-503

[Download PDF](#)

[Article preview](#)

66. select article Ontology-based Sequence Labelling for Automated Information Extraction for Supporting Bridge Data Analytics

Research articleOpen access

Ontology-based Sequence Labelling for Automated Information Extraction for Supporting Bridge Data Analytics

Kaijian Liu, Nora El-Gohary

Pages 504-510

[Download PDF](#)

Article preview

67. select article Building Lighting Energy Consumption Prediction for Supporting Energy Data Analytics

Research articleOpen access

Building Lighting Energy Consumption Prediction for Supporting Energy Data Analytics

Kadir Amasyali, Nora El-Gohary

Pages 511-517

[Download PDF](#)

Article preview

68. select article Text Analytics for Supporting Stakeholder Opinion Mining for Large-scale Highway Projects

Research articleOpen access

Text Analytics for Supporting Stakeholder Opinion Mining for Large-scale Highway Projects

Xuan Lv, Nora El-Gohary

Pages 518-524

[Download PDF](#)

Article preview

69. select article Optimization of Sustainability and Flood Hazard Resilience for Home Designs

Research articleOpen access

Optimization of Sustainability and Flood Hazard Resilience for Home Designs
Elizabeth Matthews, Carol J. Friedland, Fatemeh Orooji

Pages 525-531

[Download PDF](#)

Article preview

70. select article Linking Building Energy-Load Variations with Occupants' Energy-Use Behaviors in Commercial Buildings: Non-Intrusive Occupant Load Monitoring (NIOLM)

Research articleOpen access

Linking Building Energy-Load Variations with Occupants' Energy-Use Behaviors in Commercial Buildings: Non-Intrusive Occupant Load Monitoring (NIOLM)

Hamed Nabizadeh Rafsanjani, Changbum Ahn

Pages 532-539

[Download PDF](#)

Article preview

71. select article Impact Assessment of Stormwater Alternatives on Generated Runoff in Cities Experiencing Urban Decline

Research articleOpen access

Impact Assessment of Stormwater Alternatives on Generated Runoff in Cities Experiencing Urban Decline

Kasey M. Faust, Dulcy M. Abraham

Pages 540-547

[Download PDF](#)

Article preview

72. select article Factors Affecting Social Sustainability in Highway Projects in Missouri

Research articleOpen access

Factors Affecting Social Sustainability in Highway Projects in Missouri
Mohamed Abdel-Raheem, Charles Ramsbottom

Pages 548-555

[Download PDF](#)

Article preview

73. select article Impact Analysis on the Variations of the Thermo-physical Property of Building Envelopes and Occupancy in Building Energy Performance Assessment

Research articleOpen access

Impact Analysis on the Variations of the Thermo-physical Property of Building Envelopes and Occupancy in Building Energy Performance Assessment
Jaehyuk Lee, Youngjib Ham

Pages 556-564

[Download PDF](#)

Article preview

74. select article Evolutionary Multi-objective Optimization in Building Retrofit Planning Problem

Research articleOpen access

Evolutionary Multi-objective Optimization in Building Retrofit Planning Problem
Hyojoo Son, Changwan Kim

Pages 565-570

[Download PDF](#)

Article preview

75. select article Automated 3D Model Reconstruction to Support Energy-efficiency

Research articleOpen access

Automated 3D Model Reconstruction to Support Energy-efficiency
Hyojoo Son, Sungwook Lee, Changwan Kim

Pages 571-578

[Download PDF](#)

Article preview

76. select article Experiential and Project-based Learning in BIM for Sustainable Living with Tiny Solar Houses

Research articleOpen access

Experiential and Project-based Learning in BIM for Sustainable Living with Tiny Solar Houses

Wei Wu, Brad Hyatt

Pages 579-586

[Download PDF](#)

Article preview

77. select article Project Complexity Indicators and Management Strategies – A Delphi Study

Research articleOpen access

Project Complexity Indicators and Management Strategies – A Delphi Study
Sharareh Kermanshachi, Bac Dao, Jennifer Shane, Stuart Anderson

Pages 587-594

[Download PDF](#)

Article preview

78. select article Light Management Lessons from Nature for Building Applications

Research articleOpen access

Light Management Lessons from Nature for Building Applications
Lidia Badarnah

Pages 595-602

[Download PDF](#)

Article preview

79. select article An Empirical Study into Identifying Project Complexity Management Strategies

Research articleOpen access

An Empirical Study into Identifying Project Complexity Management Strategies

Sharareh Kermanshachi, Bac Dao, Jennifer Shane, Stuart Anderson

Pages 603-610

[Download PDF](#)

Article preview

80. select article Solar Might not Always be a Green Source of Energy

Research articleOpen access

Solar Might not Always be a Green Source of Energy
D. Jácome Polit, D. Maldonado, D. Dávalos

Pages 611-621

[Download PDF](#)

Article preview

81. select article A Study on Assessment of Non-conformances Using Multiple Domain Matrix: A Case Study from Metro Projects

Research articleOpen access

A Study on Assessment of Non-conformances Using Multiple Domain Matrix: A Case Study from Metro Projects

J. Uma Maheswari, V. Paul C. Charlesraj, G. Sandeep Kumar, S.P. Sreenivas Padala

Pages 622-629

[Download PDF](#)

Article preview

82. select article Building Glass OITC in Warm Temperature

Research articleOpen access

Building Glass OITC in Warm Temperature

Christina Mediasatika, Luciana Kristanto, Juliana Anggono, Fefen Suhedi, Hariyati Purwaningsih

Pages 630-637

[Download PDF](#)

Article preview

83. select article Topology Optimization and Advanced Manufacturing as a Means for the Design of Sustainable Building Components

Research articleOpen access

Topology Optimization and Advanced Manufacturing as a Means for the Design of Sustainable Building Components

Mark Donofrio

Pages 638-645

[Download PDF](#)

Article preview

84. select article Design of Multi-agent Emergency Dispatching Model to Strengthen Resiliency of Taiwan High-speed Rail System

Research articleOpen access

Design of Multi-agent Emergency Dispatching Model to Strengthen Resiliency of Taiwan High-speed Rail System

Ting-Wu Ho, Te-Che Chen, Chuen-Chyi Hsieh, Chien-Cheng Chou

Pages 646-653

[Download PDF](#)

Article preview

85. select article Achieving Sustainable Structural Steel Design by Estimating Fabrication Labor Cost Based on BIM Data

Research articleOpen access

Achieving Sustainable Structural Steel Design by Estimating Fabrication Labor Cost Based on BIM Data

Arash Mohsenijam, Ming Lu

Pages 654-661

[Download PDF](#)

Article preview

86. select article Women and Accidents: The Need to Separate Gender Database

Research articleOpen access

Women and Accidents: The Need to Separate Gender Database

Fernanda Cruz Rios, Wai K. Chong, David Grau

Pages 662-669

[Download PDF](#)

[Article preview](#)

87. select article Integrated Construction Process for Green Building

Research articleOpen access

Integrated Construction Process for Green Building

Yong Han Ahn, Chan Woo Jung, Minjae Suh, Myung Hwa Jeon

Pages 670-676

[Download PDF](#)

[Article preview](#)

88. select article Innovations on Management of Sustainable Construction in a Large Earthwork Project: An Australian Case Research

Research articleOpen access

Innovations on Management of Sustainable Construction in a Large Earthwork Project: An Australian Case Research

William Li, Xungai Wang

Pages 677-684

[Download PDF](#)

[Article preview](#)

89. select article Risk-based Maintenance Management of U.S. Public School Facilities

Research articleOpen access

Risk-based Maintenance Management of U.S. Public School Facilities

Deborah E. Dickerson, Paul J. Ackerman

Pages 685-692

[Download PDF](#)

Article preview

90. select article State of the Non-operations Based Research of Hard Shoulder Running

Research articleOpen access

State of the Non-operations Based Research of Hard Shoulder Running
Sean Coffey, Seri Park

Pages 693-698

[Download PDF](#)

Article preview

91. select article Avoiding Snow and Ice Formation on Exterior Solar Cell Surfaces – A Review of Research Pathways and Opportunities

Research articleOpen access

Avoiding Snow and Ice Formation on Exterior Solar Cell Surfaces – A Review of Research Pathways and Opportunities

Bjørn Petter Jelle, Tao Gao, Sohrab Alex Mofid, Tore Kolås, ...
Serina Ng

Pages 699-706

[Download PDF](#)

Article preview

92. select article Structural Assessment of Fiber-reinforced Polymer Composite Electric Poles

Research articleOpen access

Structural Assessment of Fiber-reinforced Polymer Composite Electric Poles
Girum Urgessa, Sara Mohamadi

Pages 707-714

[Download PDF](#)

Article preview

93. select article The Mechanism of how Design Failures cause Unsafe Behavior: The Cognitive Reliability and Error Analysis Method (CREAM)

Research articleOpen access

The Mechanism of how Design Failures cause Unsafe Behavior: The Cognitive Reliability and Error Analysis Method (CREAM)

Pin-Chao Liao, Xintong Luo, Tao Wang, Yusong Su

Pages 715-722

[Download PDF](#)

Article preview

94. select article Building Integration of Aerogel Glazings

Research articleOpen access

Building Integration of Aerogel Glazings

Tao Gao, Bjørn Petter Jelle, Arild Gustavsen

Pages 723-728

[Download PDF](#)

Article preview

95. select article Automatic Logical Inconsistency Detection in the National Bridge Inventory

Research articleOpen access

Automatic Logical Inconsistency Detection in the National Bridge Inventory

Zia Ud Din, Pingbo Tang

Pages 729-737

[Download PDF](#)

Article preview

96. select article Preferred Attributes of Waste Separation Behaviour: An Empirical Study

Research articleOpen access

Preferred Attributes of Waste Separation Behaviour: An Empirical Study
Low Sheau-Ting, Tee Sin-Yee, Choong Weng-Wai

Pages 738-745

[Download PDF](#)

Article preview

97. select article Use of Best Value Model to Achieve Sustainability: A Case Study on a Semiconductor Manufacturer

Research articleOpen access

Use of Best Value Model to Achieve Sustainability: A Case Study on a Semiconductor Manufacturer

Rick Corea, Dean Kashiwagi, Dhaval Gajjar, Sylvia Romero

Pages 746-751

[Download PDF](#)

Article preview

98. select article Evaluation of Synthetic Aperture Radar Satellite Remote Sensing for Pavement and Infrastructure Monitoring

Research articleOpen access

Evaluation of Synthetic Aperture Radar Satellite Remote Sensing for Pavement and Infrastructure Monitoring

Abdulkadir Ozden, Ardeshir Faghri, Mingxin Li, Kaz Tabrizi

Pages 752-759

[Download PDF](#)

Article preview

99. select article An Assessment of the Asphalt Shingle Roofing Process for Residential Buildings

Research articleOpen access

An Assessment of the Asphalt Shingle Roofing Process for Residential Buildings

Althea Arnold

Pages 760-765

[Download PDF](#)

Article preview

100. select article An Empirical Study on the Energy Consumption in Residential Buildings after Adopting Green Building Standards

Research articleOpen access

An Empirical Study on the Energy Consumption in Residential Buildings after Adopting Green Building Standards

Dong Zhao, Andrew McCoy, Jing Du

Pages 766-773

[Download PDF](#)

Article preview

1. Research articleOpen access
Evaluation and Analysis of Wind Flow for a Football Stadium
Weijun Mei, Ming Qu.

Pages 774-781

[Download PDF](#)

Article preview

2. select article Achieving Net Zero Water in Severe Drought Prone Areas: A Case Study of Catchment, Storage, and Infiltration Optimization

Research articleOpen access

Achieving Net Zero Water in Severe Drought Prone Areas: A Case Study of Catchment, Storage, and Infiltration Optimization

Courtney Crosson

Pages 782-789

[Download PDF](#)

[Article preview](#)

3. select article Knowledge Economy: A Panacea for Sustainable Development in Nigeria.

Research articleOpen access

Knowledge Economy: A Panacea for Sustainable Development in Nigeria.

Adedamola Ogundeinde, Obuks Ejohwomu

Pages 790-795

[Download PDF](#)

[Article preview](#)

4. select article Analysis of the Bolted Connection of a Bamboo Composite I-Shaped Beam Subjected to Bending

Research articleOpen access

Analysis of the Bolted Connection of a Bamboo Composite I-Shaped Beam Subjected to Bending

Hernan Castaneda, Sigridur Bjarnadottir

Pages 796-803

[Download PDF](#)

[Article preview](#)

5. select article Achieving Greater Project Success & Profitability through Pre-construction Planning: A Case-based Study

Research articleOpen access

Achieving Greater Project Success & Profitability through Pre-construction Planning: A Case-based Study

Ali Abbas, Zia Ud Din, Rizwan Farooqui

Pages 804-811

[Download PDF](#)

[Article preview](#)

6. select article Comparing Building Information Modeling Skills of Project Managers and BIM Managers Based on Social Media Analysis

Research articleOpen access

Comparing Building Information Modeling Skills of Project Managers and BIM Managers Based on Social Media Analysis

Rahimi A. Rahman, Suleiman Alsafouri, Pingbo Tang, Steven K. Ayer

Pages 812-819

[Download PDF](#)

[Article preview](#)

7. select article The Impact of Urban Form Configuration on the Urban Heat Island: The Case Study of Baghdad, Iraq

Research articleOpen access

The Impact of Urban Form Configuration on the Urban Heat Island: The Case Study of Baghdad, Iraq

Dhirgham Alobaydi, Mohammed A. Bakarman, Bushra Obeidat

Pages 820-827

[Download PDF](#)

Article preview

8. select article Pavement Skid Number and Horizontal Curve Safety

Research articleOpen access

Pavement Skid Number and Horizontal Curve Safety

K. Musey, S. Park

Pages 828-835

[Download PDF](#)

Article preview

9. select article Exploring Aggressive Driving Behavior in Pennsylvania's Delaware Valley Region

Research articleOpen access

Exploring Aggressive Driving Behavior in Pennsylvania's Delaware Valley Region

Patrick McTish, Seri Park

Pages 836-843

[Download PDF](#)

Article preview

10. select article The Importance of Integrating LCA into the LEED Rating System

Research articleOpen access

The Importance of Integrating LCA into the LEED Rating System

Hamoud Dekkiche, Ali Taileb

Pages 844-851

[Download PDF](#)

Article preview

11. select article Data-Driven Methodology for Energy and Peak Load Reduction of Residential HVAC Systems

Research articleOpen access

Data-Driven Methodology for Energy and Peak Load Reduction of Residential HVAC Systems

Kristen Sara Cetin, Catilyn Kallus

Pages 852-859

[Download PDF](#)

Article preview

12. select article Estimating Soil Classification Via Quantitative and Qualitative Field Testing for Use in Constructing Compressed Earth Blocks

Research articleOpen access

Estimating Soil Classification Via Quantitative and Qualitative Field Testing for Use in Constructing Compressed Earth Blocks

Jase D. Sitton, Brett A. Story

Pages 860-867

[Download PDF](#)

Article preview

13. select article Structural Impairment Detection Using Deep Counter Propagation Neural Networks

Research articleOpen access

Structural Impairment Detection Using Deep Counter Propagation Neural Networks

Yasha Zeinali, Brett Story

Pages 868-875

[Download PDF](#)

Article preview

14. select article What is Neighborhood Context and Why does it Matter in Sustainability Assessment?

Research articleOpen access

What is Neighborhood Context and Why does it Matter in Sustainability Assessment?

Ali Komeily, Ravi S. Srinivasan

Pages 876-883

[Download PDF](#)

Article preview

15. select article Model-based Building Performance Evaluation and Analysis for a New Athletic Training Facility

Research articleOpen access

Model-based Building Performance Evaluation and Analysis for a New Athletic Training Facility

Zhongdi Chen, Ming Qu

Pages 884-891

[Download PDF](#)

Article preview

16. select article The Effect of Positions of Vertical Glass Fins inside a Double Skin Façade Air Cavity as Acoustical Barriers and Ventilation Potentials

Research articleOpen access

The Effect of Positions of Vertical Glass Fins inside a Double Skin Façade Air Cavity as Acoustical Barriers and Ventilation Potentials

Jeehwan Lee, Haider Mohamed, Jae D. Chang

Pages 892-899

[Download PDF](#)

Article preview

17. select article Water Resources Vulnerability Assessment of MENA Countries Considering Energy and Virtual Water Interactions

Research articleOpen access

Water Resources Vulnerability Assessment of MENA Countries Considering Energy and Virtual Water Interactions

Mohammad Al-Saidi, Diana Birnbaum, Renata Buriti, Elena Diek, ... Désirée Woinowski

Pages 900-907

[Download PDF](#)

Article preview

18. select article The Use and Performance of Alternative Contracting Methods on Small Highway Construction Projects

Research articleOpen access

The Use and Performance of Alternative Contracting Methods on Small Highway Construction Projects

Douglas Alleman, Arthur Antoine, Mia Schrilla, Keith Molenaar

Pages 908-915

[Download PDF](#)

Article preview

19. select article Towards Urban Facilities Energy Performance Evaluation Using Remote Sensing

Research articleOpen access

Towards Urban Facilities Energy Performance Evaluation Using Remote Sensing

Farrokh Jazizadeh, Mohammad Taleghani

Pages 916-923

[Download PDF](#)

[Article preview](#)

20. select article The Hidden Potential behind the City Planned for Cars

Research articleOpen access

The Hidden Potential behind the City Planned for Cars
D. Dávalos, D. Maldonado, D. Jácome Polit

Pages 924-931

[Download PDF](#)

[Article preview](#)

21. select article Using PIPS to Minimize Causes of Delay in Saudi Arabian Construction Projects: University Case Study

Research articleOpen access

Using PIPS to Minimize Causes of Delay in Saudi Arabian Construction Projects: University Case Study
Majed Alzara, Jacob Kashiwagi, Dean Kashiwagi, Abdulrahman Al-Tassan

Pages 932-939

[Download PDF](#)

[Article preview](#)

22. select article Introducing a New Risk Management Model to the Saudi Arabian Construction Industry

Research articleOpen access

Introducing a New Risk Management Model to the Saudi Arabian Construction Industry
Mohammed Algahtany, Yasir Alhammadi, Dean Kashiwagi

Pages 940-947

[Download PDF](#)

[Article preview](#)

23. select article A Long-term Solution to Overcome the Problems Caused by Droughts in the Brazilian Power Systems

Research articleOpen access

A Long-term Solution to Overcome the Problems Caused by Droughts in the Brazilian Power Systems

Carlos Oliveira, Charles Zulanis, Dean Kashiwagi

Pages 948-955

[Download PDF](#)

[Article preview](#)

24. select article Artificial Versus Natural Light Source Identification with Light Intensity Sensors for Energy Monitoring

Research articleOpen access

Artificial Versus Natural Light Source Identification with Light Intensity Sensors for Energy Monitoring

Farrokh Jazizadeh, Jue Wang

Pages 956-963

[Download PDF](#)

[Article preview](#)

25. select article An Approach for Performing Life Cycle Impact Assessment of Pavements for Evaluating Alternative Pavement Designs

Research articleOpen access

An Approach for Performing Life Cycle Impact Assessment of Pavements for Evaluating Alternative Pavement Designs

Sundeeep Inti, Megha Sharma, Vivek Tandon

Pages 964-971

[Download PDF](#)

Article preview

26. select article Necessity of Including Maintenance Traffic Delay Emissions in Life Cycle Assessment of Pavements

Research articleOpen access

Necessity of Including Maintenance Traffic Delay Emissions in Life Cycle Assessment of Pavements

Sundeeep Inti, Sofia A. Martin, Vivek Tandon

Pages 972-979

[Download PDF](#)

Article preview

27. select article Using Knowledge-automation Expert Systems to Enhance the Use and Understanding of Traffic Monitoring Data in State DOTs

Research articleOpen access

Using Knowledge-automation Expert Systems to Enhance the Use and Understanding of Traffic Monitoring Data in State DOTs

Abdulkadir Ozden, Ardeshir Faghri, Mingxin Li

Pages 980-986

[Download PDF](#)

Article preview

28. select article The Effect of Exterior and Interior Roof Thermal Radiation on Buildings Cooling Energy

Research articleOpen access

The Effect of Exterior and Interior Roof Thermal Radiation on Buildings Cooling Energy

Haider I. Mohamed, Jeehwan Lee, Jae D. Chang

Pages 987-994

[Download PDF](#)

[Article preview](#)

29. select article A Study of Socioeconomic Impacts of Renewable Energy Projects in Afghanistan

Research articleOpen access

A Study of Socioeconomic Impacts of Renewable Energy Projects in Afghanistan

Ahmad Shoaib, Samuel Ariaratnam

Pages 995-1003

[Download PDF](#)

[Article preview](#)

30. select article Waste Water Force Main Pipe Construction Alternatives to Protect Existing Foundations in the City of Chandler: Case Study

Research articleOpen access

Waste Water Force Main Pipe Construction Alternatives to Protect Existing Foundations in the City of Chandler: Case Study

Jonghoon Kim, Andrew Baird, Dan D. Koo, Samuel T. Ariaratnam, Wai K.O. Chong

Pages 1004-1012

[Download PDF](#)

[Article preview](#)

31. select article Alternative Approaches for Development of a Construction-specific Decision Support Tool for Sustainable Construction Operations

Research articleOpen access

Alternative Approaches for Development of a Construction-specific Decision Support Tool for Sustainable Construction Operations

Edgar P. Small, Mansoor Al Mazrooei

Pages 1013-1020

[Download PDF](#)

[Article preview](#)

32. select article Evaluation of Construction-specific Provisions of Sustainable Design Codes and Standards in the United Arab Emirates

Research articleOpen access

Evaluation of Construction-specific Provisions of Sustainable Design Codes and Standards in the United Arab Emirates

Edgar P. Small, Mansoor Al Mazrooei

Pages 1021-1028

[Download PDF](#)

[Article preview](#)

33. select article Non-destructive Strength Evaluation of Fly Ash Based Geopolymer Concrete Using Piezo Sensors

Research articleOpen access

Non-destructive Strength Evaluation of Fly Ash Based Geopolymer Concrete Using Piezo Sensors

V. Talakokula, Vaibhav, S. Bhalla

Pages 1029-1035

[Download PDF](#)

Article preview

34. select article Determining and Validating Thermal Strain in Asphalt Concrete

Research articleOpen access

Determining and Validating Thermal Strain in Asphalt Concrete

Mohammad Hossain, Mir Azam, Rohit Mehta, Naushad Shaik, ...
Rafiqul Tarefder

Pages 1036-1043

[Download PDF](#)

Article preview

35. select article Determining the Effect of Aging on the Air Void of Asphalt Concrete for Sustainable Pavement

Research articleOpen access

Determining the Effect of Aging on the Air Void of Asphalt Concrete for Sustainable Pavement

Md Rashadul Islam, Shaikh Ahmad, Rafiqul A. Tarefder

Pages 1044-1050

[Download PDF](#)

Article preview

36. select article BIM-based Damage Estimation of Buildings under Earthquake Loading Condition

Research articleOpen access

BIM-based Damage Estimation of Buildings under Earthquake Loading Condition

Mehdi Alirezaei, Mehdi Noori, Omer Tatari, Kevin R. Mackie,
Ahmed Elgamal

Pages 1051-1058

[Download PDF](#)

Article preview

37. select article A Non-stationary Analysis Using Ensemble Empirical Mode Decomposition to Detect Anomalies in Building Energy Consumption

Research articleOpen access

A Non-stationary Analysis Using Ensemble Empirical Mode Decomposition to Detect Anomalies in Building Energy Consumption

Hariharan Naganathan, Wai K. Chong, Zigang Huang, Ying Cheng

Pages 1059-1065

[Download PDF](#)

Article preview

38. select article Reducing Time and Cost of Construction Projects by Improving the Properties of Precast Normal-weight Wall Panels

Research articleOpen access

Reducing Time and Cost of Construction Projects by Improving the Properties of Precast Normal-weight Wall Panels

AL. kulabi Ahmed, Hakob Avetisyan

Pages 1066-1073

[Download PDF](#)

Article preview

39. select article The Causes of the Municipal Solid Waste and the Greenhouse Gas Emissions from the Waste Sector in the United States

Research articleOpen access

The Causes of the Municipal Solid Waste and the Greenhouse Gas Emissions from the Waste Sector in the United States

Seungtaek Lee, Jonghoon Kim, Wai Oswald Chong

Pages 1074-1079

[Download PDF](#)

Article preview

40. select article To Investigation of Plastic Concrete Bentonite Changes on it's Physical Properties

Research articleOpen access

To Investigation of Plastic Concrete Bentonite Changes on it's Physical Properties

Sina Kazemian, Soheil Ghareh, Leili Torkanloo

Pages 1080-1087

[Download PDF](#)

Article preview

41. select article Benchmarking Energy Management Systems in Metro Stations

Research articleOpen access

Benchmarking Energy Management Systems in Metro Stations

Samira Rajabi, Salwa Behairy

Pages 1088-1095

[Download PDF](#)

Article preview

42. select article Sustainability Assessment of Complex Energy Systems Using Life Cycle Approach-Case Study: Arizona State University Tempe Campus

Research articleOpen access

Sustainability Assessment of Complex Energy Systems Using Life Cycle Approach-Case Study: Arizona State University Tempe Campus
S. Moslehi, R. Arababadi

Pages 1096-1103

[Download PDF](#)

Article preview

43. select article Photovoltaic Energy Variations Due to Roofing Choice

Research articleOpen access

Photovoltaic Energy Variations Due to Roofing Choice
Mohammed Alshayeb, Jae D Chang

Pages 1104-1109

[Download PDF](#)

Article preview

44. select article Exploring the Adoption of BIM in the UAE Construction Industry for AEC Firms

Research articleOpen access

Exploring the Adoption of BIM in the UAE Construction Industry for AEC Firms
Donya Mehran

Pages 1110-1118

[Download PDF](#)

Article preview

45. select article How to Use In-situ Soils as Building Materials

Research articleOpen access

How to Use In-situ Soils as Building Materials
Q.-B. Bui, J.-C. Morel, V.-H. Tran, S. Hans, M. Oggero

Pages 1119-1126

[Download PDF](#)

Article preview

46. select article Solutions to Sustainability in Construction: Some Examples

Research articleOpen access

Solutions to Sustainability in Construction: Some Examples

Jian Chu

Pages 1127-1134

[Download PDF](#)

Article preview

47. select article A Review of the Benefits of Geothermal Heat Pump Systems in Retail Buildings

Research articleOpen access

A Review of the Benefits of Geothermal Heat Pump Systems in Retail Buildings

Jeffrey Molavi, James McDaniel

Pages 1135-1143

[Download PDF](#)

Article preview

48. select article Bridging the Knowledge Gap between Fire Engineers and Building Service Engineers - Using the Analytic Hierarchy Process Approach

Research articleOpen access

Bridging the Knowledge Gap between Fire Engineers and Building Service Engineers - Using the Analytic Hierarchy Process Approach

R. Doheim, Y.A. Yohanis, A. Nadjai, H. Elkadi

Pages 1144-1152

[Download PDF](#)

[Article preview](#)

49. select article Sustainable Design of Deconstructable Steel-Concrete Composite Structures

Research articleOpen access

Sustainable Design of Deconstructable Steel-Concrete Composite Structures
Abdolreza Ataei, Mark A. Bradford, Hamid Valipour

Pages 1153-1160

[Download PDF](#)

[Article preview](#)

50. select article Assessment and Review of Performance Levels of Concrete Structure Designed in Accordance with ACI 318-99 and UBC 97 Regulations

Research articleOpen access

Assessment and Review of Performance Levels of Concrete Structure
Designed in Accordance with ACI 318-99 and UBC 97 Regulations
Reza Mokarram Aydenloo, Javad Mokari Rahmdel, Erfan Shafei

Pages 1161-1168

[Download PDF](#)

[Article preview](#)

51. select article A framework for Organizing a Resilient Cost Benefit Analysis for Construction Projects

Research articleOpen access

A framework for Organizing a Resilient Cost Benefit Analysis for Construction
Projects

Alemu Moges Belay, Olav Torp, Carl Thodesen, James Odeck

Pages 1169-1176

[Download PDF](#)

Article preview

52. select article Cost Development Over-time at Construction Planning Phase: Empirical Evidence from Norwegian Construction Projects

Research articleOpen access

Cost Development Over-time at Construction Planning Phase: Empirical Evidence from Norwegian Construction Projects

Olav Torp, Alemu Moges Belay, Carl Thodesen, Ole Jonny Klakegg

Pages 1177-1184

[Download PDF](#)

Article preview

53. select article Seismic Assessment of Rammed Earth Walls Using Pushover Tests

Research articleOpen access

Seismic Assessment of Rammed Earth Walls Using Pushover Tests

R. Nabouch, Q.B. Bui, O. Plé, P. Perrotin, ... J.P. Plassiard

Pages 1185-1192

[Download PDF](#)

Article preview

54. select article Nonlinear Performance Evaluation of Diagonally and X-Braced Moment Resisting Frame Systems: Buckling and Post-Buckling Responses

Research articleOpen access

Nonlinear Performance Evaluation of Diagonally and X-Braced Moment Resisting Frame Systems: Buckling and Post-Buckling Responses

M. Lotfollahi, M.M. Alinia, E. Taciroglu

Pages 1193-1200

[Download PDF](#)

[Article preview](#)

55. select article Use of Contaminated Sludge in Concrete

Research articleOpen access

Use of Contaminated Sludge in Concrete

Daniel de Almeida Lima, Charles Zulanans

Pages 1201-1208

[Download PDF](#)

[Article preview](#)

56. select article Key Lessons and Guidelines for Post-Disaster Permanent Housing Provision in Kelantan, Malaysia

Research articleOpen access

Key Lessons and Guidelines for Post-Disaster Permanent Housing Provision in Kelantan, Malaysia

Ruhizal Roosli, Andrew E. Collins

Pages 1209-1217

[Download PDF](#)

[Article preview](#)

57. select article Splitting Tensile Strength of Sustainable self-consolidating Concrete

Research articleOpen access

Splitting Tensile Strength of Sustainable self-consolidating Concrete

Osama A. Mohamed, Zubair I. Syed, Omar F. Najm

Pages 1218-1225

[Download PDF](#)

Article preview

58. select article An Exploratory Study of Relationships between National Culture and Infrastructure Sustainability

Research articleOpen access

An Exploratory Study of Relationships between National Culture and Infrastructure Sustainability

Junna Meng, Jinghong Yan, Bingsheng Liu

Pages 1226-1233

[Download PDF](#)

Article preview

59. select article Performance Evaluation of 32 LEED Hospitals on Operation Costs

Research articleOpen access

Performance Evaluation of 32 LEED Hospitals on Operation Costs

Hessam Sadatsafavi, Mardelle M. Shepley

Pages 1234-1241

[Download PDF](#)

Article preview

60. select article Utilizing BIM and Carbon Estimating Methods for Meaningful Data Representation

Research articleOpen access

Utilizing BIM and Carbon Estimating Methods for Meaningful Data Representation

Michael Mousa, Xiaowei Luo, Brenda McCabe

Pages 1242-1249

[Download PDF](#)

Article preview

61. select article More than just a Green Façade: Vertical Gardens as Active Air Conditioning Units

Research articleOpen access

More than just a Green Façade: Vertical Gardens as Active Air Conditioning Units

M.J.M. Davis, F. Ramirez, M.E. Pérez

Pages 1250-1257

[Download PDF](#)

Article preview

62. select article Know Your People: Social Research and Water Recycling System Design with Communities in the Amazon

Research articleOpen access

Know Your People: Social Research and Water Recycling System Design with Communities in the Amazon

M.J.M. Davis, M.L. Gutiérrez, J. Serrano

Pages 1258-1266

[Download PDF](#)

Article preview

63. select article Role of Lean Tools in Supporting Knowledge Creation and Performance in Lean Construction

Research articleOpen access

Role of Lean Tools in Supporting Knowledge Creation and Performance in Lean Construction

Lianying Zhang, Xi Chen

Pages 1267-1274

[Download PDF](#)

[Article preview](#)

64. select article Non-linear Finite Element Analysis of Offshore Stainless Steel Blast Wall under High Impulsive Pressure Loads

Research articleOpen access

Non-linear Finite Element Analysis of Offshore Stainless Steel Blast Wall under High Impulsive Pressure Loads

Zubair Imam Syed, Osama Ahmed Mohamed, Shaikh Atikur Rahman

Pages 1275-1282

[Download PDF](#)

[Article preview](#)

65. select article Knowledge Management in Construction Using a SocioBIM Platform: A Case Study of AYO Smart Home Project

Research articleOpen access

Knowledge Management in Construction Using a SocioBIM Platform: A Case Study of AYO Smart Home Project

Raghav Grover, Thomas M. Froese

Pages 1283-1290

[Download PDF](#)

[Article preview](#)

66. select article Analysis of Costs and Benefits of Panelized and Modular Prefabricated Homes

Research articleOpen access

Analysis of Costs and Benefits of Panelized and Modular Prefabricated Homes

Diana Lopez, Thomas M. Froese

Pages 1291-1297

[Download PDF](#)

Article preview

67. select article Energy Performance of a Solar Home Constructed for the Solar Decathlon Competition 2013

Research articleOpen access

Energy Performance of a Solar Home Constructed for the Solar Decathlon Competition 2013

Pramen P. Shrestha, Sanjib Mulepati

Pages 1298-1305

[Download PDF](#)

Article preview

68. select article Slum Development Using Zero Waste Concepts: Construction Waste Case Study

Research articleOpen access

Slum Development Using Zero Waste Concepts: Construction Waste Case Study

S.M. Elgizawy, S.M. El-Haggag, K. Nassar

Pages 1306-1313

[Download PDF](#)

Article preview

69. select article Latent Class Analysis for Highway Design and Construction Project Categorization

Research articleOpen access

Latent Class Analysis for Highway Design and Construction Project Categorization

Arthur L.C. Antoine, Keith R. Molenaar

Pages 1314-1321

[Download PDF](#)

Article preview

70. select article Life-cycle Assessment of High Performance, Low Cost Homes

Research articleOpen access

Life-cycle Assessment of High Performance, Low Cost Homes

Peixian Li, Thomas M. Froese

Pages 1322-1329

[Download PDF](#)

Article preview

71. select article Energy Retrofit of a Day Care Center for Current and Future Weather Scenarios

Research articleOpen access

Energy Retrofit of a Day Care Center for Current and Future Weather Scenarios

Amin Moazami, Salvatore Carlucci, Francesco Causone, Lorenzo Pagliano

Pages 1330-1337

[Download PDF](#)

Article preview

72. select article Use of Recycled Concrete Aggregates in Precast/Prestressed Concrete

Research articleOpen access

Use of Recycled Concrete Aggregates in Precast/Prestressed Concrete
Michael R. Brandes, Yahya C. Kurama

Pages 1338-1345

[Download PDF](#)

Article preview

73. select article Electric Grid Vulnerabilities to Rising Air
Temperatures in Arizona

Research articleOpen access

Electric Grid Vulnerabilities to Rising Air Temperatures in Arizona
Daniel Burillo, Mikhail Chester, Benjamin Ruddell

Pages 1346-1353

[Download PDF](#)

Article preview

74. select article A Proposal for Risk Allocation in Social
Infrastructure Projects Applying PPP in Colombia

Research articleOpen access

A Proposal for Risk Allocation in Social Infrastructure Projects Applying PPP
in Colombia

Lina María Sastoque, Carlos Alejandro Arboleda, Jose Luis Ponz

Pages 1354-1361

[Download PDF](#)

Article preview

75. select article A Construction Procurement Method to Achieve
Sustainability in Modular Construction

Research articleOpen access

A Construction Procurement Method to Achieve Sustainability in Modular Construction

Jeffrey Molavi, Drew L. Barral

Pages 1362-1369

[Download PDF](#)

Article preview

76. select article Creating a New Project Management Model through Research

Research articleOpen access

Creating a New Project Management Model through Research

Alfredo Rivera, Dean Kashiwagi

Pages 1370-1377

[Download PDF](#)

Article preview

77. select article Identifying the Causes of Inefficiency and Poor Performance of the Delivery of Services

Research articleOpen access

Identifying the Causes of Inefficiency and Poor Performance of the Delivery of Services

Alfredo Rivera, Jacob Kashiwagi

Pages 1378-1385

[Download PDF](#)

Article preview

78. select article Identifying the State of the Project Management Profession

Research articleOpen access

Identifying the State of the Project Management Profession
Alfredo Rivera, Jacob Kashiwagi

Pages 1386-1393

[Download PDF](#)

[Article preview](#)

79. select article The Perception of the Government and Private Sectors on the Procurement System Delivery Method in Saudi Arabia

Research articleOpen access

The Perception of the Government and Private Sectors on the Procurement System Delivery Method in Saudi Arabia

Ahmed Alofi, Jacob Kashiwagi, Dean Kashiwagi

Pages 1394-1401

[Download PDF](#)

[Article preview](#)

80. select article Owners' Perspective of Factors Contributing to Project Delay: Case Studies of Road and Bridge Projects in Saudi Arabia

Research articleOpen access

Owners' Perspective of Factors Contributing to Project Delay: Case Studies of Road and Bridge Projects in Saudi Arabia

Ghazi Saad A. Elawi, Mohammed Algahtany, Dean Kashiwagi

Pages 1402-1409

[Download PDF](#)

[Article preview](#)

81. select article Development of a Sustainable National Sewer Inventory

Research articleOpen access

Development of a Sustainable National Sewer Inventory
Phil Lewis, Hossein Khaleghian, Yongwei Shan

Pages 1410-1415

[Download PDF](#)

Article preview

82. select article Construction Quality Assessment Using 3D as-built Models Generated with Project Tango

Research articleOpen access

Construction Quality Assessment Using 3D as-built Models Generated with Project Tango

T. Sri Kalyan, Puyan A. Zadeh, Sheryl Staub-French, Thomas M. Froese

Pages 1416-1423

[Download PDF](#)

Article preview

83. select article Assessment of the Impact of Window Size, Position and Orientation on Building Energy Load Using BIM

Research articleOpen access

Assessment of the Impact of Window Size, Position and Orientation on Building Energy Load Using BIM

Soojung Kim, Puyan A. Zadeh, Sheryl Staub-French, Thomas Froese, Belgin Terim Cavka

Pages 1424-1431

[Download PDF](#)

Article preview

84. select article Water Management Lessons from Nature for Applications to Buildings

Research articleOpen access

Water Management Lessons from Nature for Applications to Buildings
Lidia Badarnah

Pages 1432-1439

[Download PDF](#)

Article preview

85. select article Framework to Assess City-scale Sustainability

Research articleOpen access

Framework to Assess City-scale Sustainability
Malini Srivastava

Pages 1440-1447

[Download PDF](#)

Article preview

86. select article Batteries as a Service: A New Look at Electricity
Peak Demand Management for Houses in the UK

Research articleOpen access

Batteries as a Service: A New Look at Electricity Peak Demand Management
for Houses in the UK

M.J.M. Davis, P. Hiralal

Pages 1448-1455

[Download PDF](#)

Article preview

87. select article BIM-enabled Modular and Industrialized
Construction in China

Research articleOpen access

BIM-enabled Modular and Industrialized Construction in China

Jinyue Zhang, Yating Long, Siquan Lv, Yunchao Xiang

Pages 1456-1461

[Download PDF](#)

Article preview

88. select article The Current State of Research and Development Approach (R&D) in the Saudi Construction Industry

Research articleOpen access

The Current State of Research and Development Approach (R&D) in the Saudi Construction Industry

Yasir Alhammadi, Mohammed Algahtany, Dean Kashiwagi, Kenneth Sullivan, Jacob Kashiwagi

Pages 1462-1469

[Download PDF](#)

Article preview

89. select article The Role of Small Commercial Buildings in Achieving Energy Efficiency: Case Study Results

Research articleOpen access

The Role of Small Commercial Buildings in Achieving Energy Efficiency: Case Study Results

Khalil Santiago, Juliana Vazquez, Kristen Parrish

Pages 1470-1477

[Download PDF](#)

Article preview

90. select article Optimized Reinforcement Detailing Design for Sustainable Construction: Slab Case Study

Research articleOpen access

Optimized Reinforcement Detailing Design for Sustainable Construction: Slab Case Study

Chaoyu Zheng, Ming Lu

Pages 1478-1485

[Download PDF](#)

[Article preview](#)

91. select article A Framework for Identifying Causal Factors of Delay in Nuclear Power Plant Projects

Research articleOpen access

A Framework for Identifying Causal Factors of Delay in Nuclear Power Plant Projects

Samer Alsharif, Aslihan Karatas

Pages 1486-1492

[Download PDF](#)

[Article preview](#)

92. select article Evaluating the Performance of Public Involvement for Sustainable Urban Regeneration

Research articleOpen access

Evaluating the Performance of Public Involvement for Sustainable Urban Regeneration

Ling Li, Guangbin Hong, Anmin Wang, Bingsheng Liu, Zhi Li

Pages 1493-1500

[Download PDF](#)

[Article preview](#)

93. select article Review and Prospect of Studies on Emergency Management

Research articleOpen access

Review and Prospect of Studies on Emergency Management
Bingsheng Liu, Xue Zhao, Yan Li

Pages 1501-1508

[Download PDF](#)

[Article preview](#)

94. select article Group Decision Making Model of Urban
Renewal Based on Sustainable Development: Public Participation
Perspective

Research articleOpen access

Group Decision Making Model of Urban Renewal Based on Sustainable
Development: Public Participation Perspective

Anmin Wang, Yang Hu, Ling Li, Bingsheng Liu

Pages 1509-1517

[Download PDF](#)

[Article preview](#)

95. select article Recycled Construction Debris as Concrete
Aggregate for Sustainable Construction Materials

Research articleOpen access

Recycled Construction Debris as Concrete Aggregate for Sustainable
Construction Materials

Shahid Kabir, Ammar Al-Shayeb, Imran M. Khan

Pages 1518-1525

[Download PDF](#)

[Article preview](#)

96. select article Using BIM to Retrofit Existing Buildings

Research articleOpen access

Using BIM to Retrofit Existing Buildings
Maggie Khaddaj, Issam Srour

Pages 1526-1533

[Download PDF](#)

[Article preview](#)

97. select article Public-private Partnership in Residential Brownfield Redevelopment: Case Studies of Pittsburgh

Research articleOpen access

Public-private Partnership in Residential Brownfield Redevelopment: Case Studies of Pittsburgh

Xiaodan Li, Hao Yang, Wenjing Li, Zhiting Chen

Pages 1534-1540

[Download PDF](#)

[Article preview](#)

98. select article Review of Nanocoatings for Building Application

Research articleOpen access

Review of Nanocoatings for Building Application

Haleh Boostani, Sama Modirrousta

Pages 1541-1548

[Download PDF](#)

[Article preview](#)

99. select article Analysis of Atrium Pattern, Trombe Wall and Solar Greenhouse on Energy Efficiency

Research articleOpen access

Analysis of Atrium Pattern, Trombe Wall and Solar Greenhouse on Energy Efficiency

Sama Modirrousta, Haleh Boostani

Pages 1549-1556

[Download PDF](#)

Article preview

100. select article Asphalt Design Using Recycled Plastic and Crumb-rubber Waste for Sustainable Pavement Construction

Research articleOpen access

Asphalt Design Using Recycled Plastic and Crumb-rubber Waste for Sustainable Pavement Construction

Imran M. Khan, Shahid Kabir, Majed A. Alhussain, Feras F. Almansoor

Pages 1557-1564

[Download PDF](#)

Article preview

1. Research articleOpen access

Relationship between 28-days Compressive Strength and Compression Toughness Factor of Ultra High Performance Concrete Using Design of Experiments

Mohammad Ali Mosaberpanah, Ozgur Eren

Pages 1565-1571

[Download PDF](#)

Article preview

2. select article Creating an Ecological Historic District: Rethinking a Chinese Challenge through the Case of Oakland District, Pittsburgh

Research articleOpen access

Creating an Ecological Historic District: Rethinking a Chinese Challenge through the Case of Oakland District, Pittsburgh

Changjuan Hu, Cong Gong

Pages 1572-1579

[Download PDF](#)

Article preview

3. select article The Way of Constructing Green Block's Eco-grid by Ecological Infrastructure Planning

Research articleOpen access

The Way of Constructing Green Block's Eco-grid by Ecological Infrastructure Planning

Cong Gong, Changjuan Hu

Pages 1580-1587

[Download PDF](#)

Article preview

4. select article Analyzing Arizona OSHA Injury Reports Using Unsupervised Machine Learning

Research articleOpen access

Analyzing Arizona OSHA Injury Reports Using Unsupervised Machine Learning

Abbas Chokor, Hariharan Naganathan, Wai K. Chong, Mounir El Asmar

Pages 1588-1593

[Download PDF](#)

Article preview



International Conference on Sustainable Design, Engineering and Construction

Building glass OITC in warm temperature

Christina Mediastika^{a*}, Luciana Kristanto^a, Juliana Anggono^b, Fefen Suhedi^c, Hariyati Purwaningsih^d

^aDepartment of Architecture Petra Christian University, Surabaya 60236, Indonesia

^bDepartment of Mechanical Engineering Petra Christian University, Surabaya 60236, Indonesia

^cResearch and Development Center for Housing and Settlement, Ministry of Public Works and Housing, Bandung 40622 Indonesia

^dDepartment of Material Engineering, Institut Sepuluh Nopember, Surabaya 60111 Indonesia

Abstract

Glass installed for building façade ideally possesses significant level of outdoor indoor transmission class (OITC) so it does not decrease OITC of conventional wall façade significantly. This study is about OITC of glass building in the temperature warmer than the one outlined by ASTM E-90, as it is commonly experienced in a tropical environment. Monolithic, laminated and tempered glass were tested using ASTM E-90 and calculation of OITC was conducted using ASTM E1332-90. Modification of room temperature was made to replicate warmer temperature like the temperature in a tropical environment, whilst other specifications was made based on ASTM E-90. The test showed that at higher frequency of 630 Hz and above, laminated glass performed slightly better insulation compared to monolithic and tempered but the OITC of laminated glass was dropped to 29, caused by a very sharp coincidence dip at frequency of 125 Hz which was 17 dB only. This explains that within temperature approximately 5°C warmer than the one outlined by ASTM E-90, laminated glass used for building façade would not perform noise insulation better; it is different from many earlier studies which concluded laminated glass had better sound insulation compared to monolithic and tempered glass in term of STC and OITC.

© 2016 The Authors. Published by Elsevier Ltd. This is an open access article under the CC BY-NC-ND license (<http://creativecommons.org/licenses/by-nc-nd/4.0/>).

Peer-review under responsibility of the organizing committee of ICSDEC 2016

Keywords: monolithic glass, laminated glass, tempered glass, warm temperature, OITC

* Corresponding author. Tel.: +62-816-489-5203; fax: +62 31 8436418.
E-mail address: eviutami@petra.ac.id

1. Window Glazing

Substitution of conventional masonry walls by glass walls is now widely applied, especially for high-rise buildings. However, glass producers and users are mostly put their outmost concern to solar and thermal control of the glass. A very little attention is put to consider sound transmission aspect. As glazing walls are usually thinner than masonry walls, the sound insulation property decreases accordingly [1,2,3]. In order to provide similar sound insulation like masonry walls, glazing walls should possess significant outdoor-indoor transmission class (OITC) close to that of masonry wall which is 43 to 49 depending on the thickness [4]. Glass manufacturers' manual shares limited information on sound insulation property of their products. When available, it is mostly in terms of sound transmission class (STC). In fact, STC is a method of predicting sound insulation property of vertical building materials which is for indoor usage such as partition wall. The STC calculation does not include low sound frequencies which exist in environmental noise, especially transportation noise. This causes STC of glass may not be directly referred for sound insulation of façade installation. OITC of such vertical building elements is usually lower than the STC caused by lower transmission loss at low frequencies, i.e. 80 Hz and 100 Hz. Coincidence dip that exists in the contour may also decrease insulation property of a material from its STC to its OITC, especially when the dips are at low frequency of 80 Hz and 100 Hz [5]. The occurrence of coincidence dip is controlled by material's stiffness and thickness and happens at the point where the sound transmitted through the material equals the natural frequency of the material installed [6,7]. The thicker and stiffer the glass is, the lower the frequency at which the 'dip' occurs is [7,8]. When specific frequencies are targeted for noise reduction, an analysis of where the frequency 'dip' appears for any glass types under consideration is important. When all of 1/3 octave band frequency is in the noise spectrum, OITC single number may be used as reference, with particular consideration to frequency at which the frequency 'dip' appears [9]. This explains STC information provided by glass manufacturers may not be directly used as OITC.

Indoor living spaces are suggested to maintain interior noise levels at 45 to 50 dBA (approx. NC 40 to 45) or lower [10,11]. Thus, replacement of masonry wall to the lighter and thinner glass wall ideally provides interior noise levels close to that of proximity by having high OITC rating with minimum coincidence dips.

2. Glass façade in Indonesia

The use of glass façade in low and high-rise buildings is also a trend in Indonesia, either for operable windows or glass walls. The fact that this thinner material provides lower noise insulation gets worse with minor installation details and improper supporting materials. These issues are very common in Indonesia, due to loose noise regulation and limited knowledge and awareness of Indonesians on noise [12].

Leading glass manufacturers in Indonesia, i.e. Asahimas glass do not provide detailed information on noise insulation capability of glass as building façade. Asahimas provides STC of glass only excluding the OITC [13]. Although currently it is not required by the International Building Code [14] nor by Indonesian Building Regulation [15] and in most cases STC is not sufficient for outdoor usage, information on façade OITC is important, especially due to rapid increment on environmental noise.

Studies on acoustical property of glass have been conducted in cities and countries with different climate to that of Indonesia. Thus, they cannot be fully adopted in Indonesia. Standard for conducting acoustical testing of partitions, including glass partitions was set to comply room temperature in the range of $22 \pm 5^\circ\text{C}$ (ASTM [16]), which rarely happens in Indonesia. Even if molecular formation of glass only responds to temperature above 600°C [17,18], a testing condition close to daily temperature in Indonesia is considered important to see whether temperature difference between ASTM and actual daily temperature in Indonesia affects sound transmission within 1/3 octave band frequency assigned. The occurrence of certain coincidence dip which would affect the OITC single number would also be observed.

In the last ten years, many cities in Indonesia have average annual temperature of 28°C as in Jakarta, the capital city [19,20,21]. The maximum temperature might reach up to 33°C [19]. Considering this issue, investigation on glass OITC in warmer daily temperature in Indonesia was carried out. The result is reported in this paper.

3. Methods

Examination of building glass OITC was performed in accordance with the following method:

- Selection of glass types was limited to: monolithic, laminated, and tempered. The selection was based on glass types commonly used for building facades. Double glass was not selected considering seldom usage in Indonesia [22].
- Thickness and dimension were set as fixed variables here. Since earlier studies significantly proved that thickness and dimension play important roles in the decrease or increase of OITC, where thicker glass owns higher OITC than thinner ones and larger glass dimension decreases OITC than smaller ones [7]. Fixed dimension of 10 mm thickness and 110 mm x 100 mm was used for all glass specimens (Fig. 1 and Fig.2). Specimen variables are monolithic, laminated, and tempered. All glass specimens were provided by Asahimas glass Indonesia. The laminated glass is composed as 5-0.375-5, which is 5 mm for pane 1, 0.375 for polyvinyl butyral (PVB) interlayer, and 5 mm for pane 2. All specimens were installed as fixed windows.
- Testing method conforming to ASTM E90-09 [15] was employed in this study and a specific condition was applied based on Annex.3 on the use of composite wall system. This was due to intact glass sample that could not be inserted into the testing room's door. The standard requires minimum height of 2.4 m, whereas the laboratory's door is limited to 2.1 m tall. For other specimens, such as bricks, gypsums, etc., it is possible to construct intact partitions part by part within the testing room where proper joint between specimens or panels will not significantly affect the transmission loss. However, this is not the case for glass because glass sheets need to be arranged by using connectors such as thick sealant, which may cause significant deviation in the testing process, and thus affects transmission loss [23].
- Reverberation chambers conforming to ASTM E90-09 [15] was utilized to conduct the test, with room layout as in Fig. 3 and Fig. 4.
- In the composite wall system employed, the use of filler wall was developed. It is suggested to use filler wall with OITC of roughly 15 above the predicted OITC of the tested specimen. In this case, light bricks plastered both sides with total thickness of 252 mm were used (Fig.1, and Fig. 2). The filler wall was tested prior to specimen installation, which provides STC 48 and OITC 42. For a reference, 10 mm monolithic glass of Pilkington provides STC 33 [24,25]. Reference of 10 mm glass thickness STC was used since OITC for this type was not available.
- Equipment used for testing was Bruel & Kjaer 2- channel building acoustic system consisting of power amplifier type 2734 and 4292 omnidirectional loud speaker as sound source, 2 pieces of type 4189 omnidirectional microphone as sound sensor, and 2-channel hand held analyzer type 2270 as the main instrument data processor. The microphones were calibrated using type 4231 prior to testing stage.
- Room temperature as a replica of outdoor temperature was set in 2 conditions, i.e. standard (conforming to ASTM E90, which is 24-26°C) and warmer (31-32°C). Indoor temperature was set to remain at standard temperature as in common indoor temperature in Indonesia conditioned by air conditioner.
- Each glass type was tested twice for both outdoor-indoor room temperature of warmer and standard and standard and standard (as in Table 1).

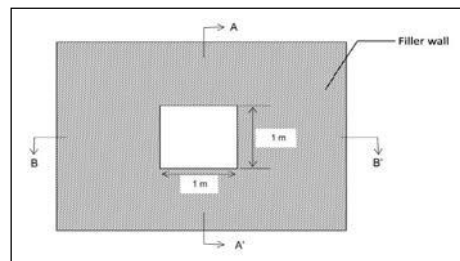

Fig. 1. Front view of the composite wall specimen

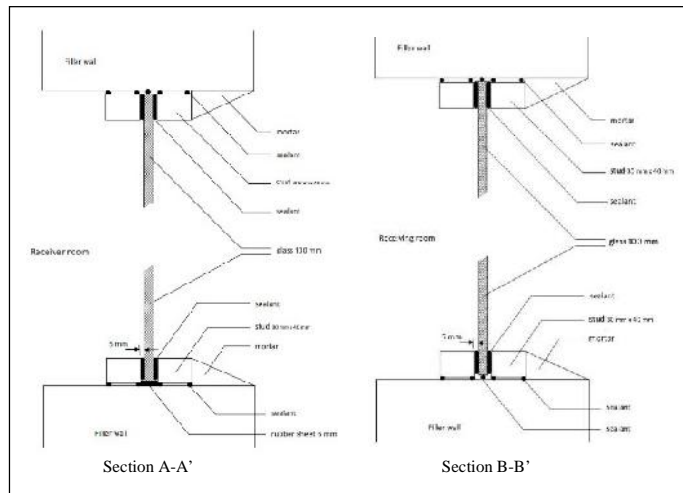

Fig. 2. Sections of the composite wall specimen

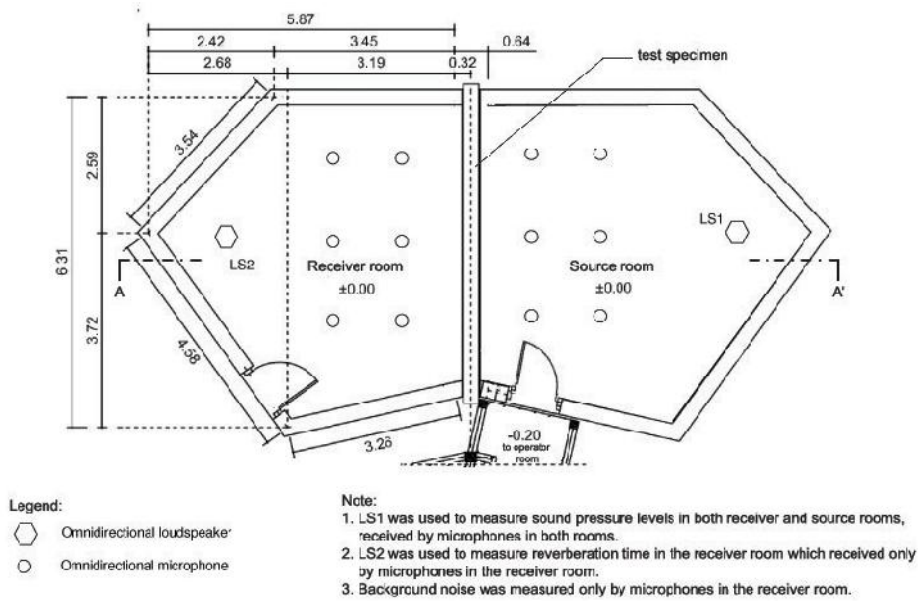

Fig. 3. Plan of the testing room and the equipment layout

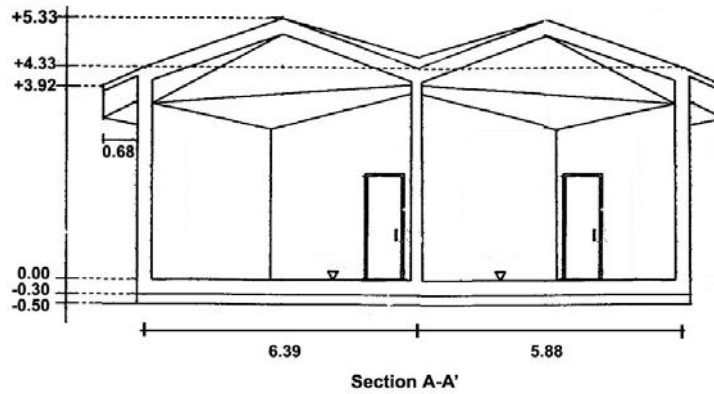

Fig.4. A-A' section of the testing room

Table 1. Specimen specification and variables

| No. | Specimen | Specification | Room temperature (°C) and humidity (%) |
|-----|------------------|---|--|
| 1 | Filler wall | Light brick + mortar, thickness 252 mm, density ± 180 kg/m ² | 26 -27°C, 60-90% |
| 2 | Monolithic glass | 1100 mm x 1000 mm, thickness 10 mm, density ± 25 kg/m ² | 26 -27°C, 60-90% |
| 3 | Monolithic glass | 1100 mm x 1000 mm, thickness 10 mm, density ± 25 kg/m ² | 31-32°C, 60-90% |
| 4 | Laminated glass | 1100 mm x 1000 mm, thickness 10 mm, density ± 25 kg/m ² | 26 -27°C, 60-90% |
| 5 | Laminated glass | 1100 mm x 1000 mm, thickness 10 mm, density ± 25 kg/m ² | 31-32°C, 60-90% |
| 6 | Tempered glass | 1100 mm x 1000 mm, thickness 10 mm, density ± 25 kg/m ² | 26 -27°C, 60-90% |
| 7 | Tempered glass | 1100 mm x 1000 mm, thickness 10 mm, density ± 25 kg/m ² | 31-32°C, 60-90% |

4. Findings and Discussion

Since composite wall system was used, particular formula to develop transmission loss (TL) of each 1/3 octave band frequency was utilized as follows [16].

$$\tau_c S_c = \tau_s S_s + \tau_f S_f \quad \text{or} \quad \tau_s = (\tau_c S_c - \tau_f S_f) / S_s$$

S_c is area of composite construction ($S_c = S_f + S_s$), S_f is area of filler element, S_s is area of test specimen, τ_c is transmission coefficient of composite construction, τ_f is transmission coefficient of filler element, and τ_s is transmission coefficient of test specimen. When the TL was drawn, OITC could be calculated. The OITC of glass is a single number rating representing sound TL data available on the test specimen in 1/3 octave band frequency from 80 Hz to 4000 Hz, inclusive, in accordance with ASTM E-90 as in Table 2 and Fig. 5. This spectrum has demonstrated reasonably reliable for aircraft and street noise on city streets [26]. It is calculated using formula as follows [27].

$$OITC = 100.13 - 10 \cdot \log \left\{ \sum_{i=80\text{Hz}}^{4000\text{Hz}} 10^{\frac{(AWRS_i - TL_i)}{10}} \right\}$$

$AWRS_i$ is the A- weighted reference sound level, and TL_i is the sound transmission loss for 1/3 octave band, i , respectively. Calculation of OITC usually resulted lower single number rating from STC caused by low frequency noise spectrum where coincidence dips appears, particularly by thin sound blocking materials [7].

This study showed that within warmer environment, compared to monolithic and tempered glass, OITC of laminated glass dropped as low as 29, which is identical to OITC of monolithic glass as thin as 6 mm [5]. Fig.5 exhibits all specimens had similar contours with dips occurring at frequency 125 Hz, 200 Hz and 1600 Hz. The sharpest dip existed at 125 Hz for laminated glass tested within warmer outdoor environment. Apart from performance of better TL at frequency above 800Hz, this coincidence dip has notably contributed to the low OITC of laminated glass. At this stage, no alteration could be made to cure the coincidence dip; increasing material thickness does not effectively address the condition [28]. This statement represents that laminated glass of different thickness may have similar performance within the particular temperature assigned. The only solution is by replacing laminated glass with other glass types or other less stiff materials. When laminated glass is still in use, damping system can be introduced. Damping by the use of flexible mounting materials will also reduce the coincidence dip depth [7, 29].

Facts of earlier studies that laminated glass owns higher OITC compared to monolithic and tempered [30] were not borne out in this study. The finding of this study that laminated glass within warmer air had lowest OITC is the opposite of the earlier study using the same specimen for calculation of STC in which laminated glass had the highest STC compared to monolithic and tempered glasses [31]. From this study, it can be learned that sound travel media which in this case is warmer air played significant role on the way how sound strike the glass specimen and that the speed of the airborne incident match to the glass bending wave [28], which in cooler or standard air was not the case.

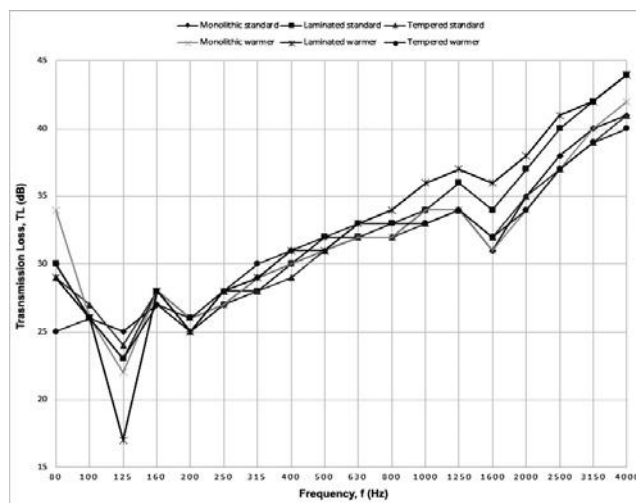

Fig.5. Transmission loss (TL) contour of glass specimen at normal temperature (26-27°C) and warmer temperature (31-32°C)

5. Conclusion

This study concludes that within warmer air temperature of approximately 5°C above temperature as outlined by ASTM E-90 (i.e. 31-32°C), a very significant dip existed in laminated glass that dropped its OITC accordingly. Thus, the selection of laminated glass for building façade within warmer environment may not be successful as in a standard or cooler environment [8,28,30,31]. More attention should be paid for real installation, since OITC rating from a laboratory test is usually higher than the OITC rating from field test, due to the flanking problems [8].

By this study it can be learned that warmer air as the medium of noise dispersion has a significant impact on the occurrence of coincidence dip of laminated glass.

Table 2. Transmission loss and OITC

| 1/3 Octave band frequency | Transmission Loss (TL) in dB & OITC against air temperature | | | | | | |
|--------------------------------|---|------------|-----------|-----------|-----------|-----------|-----------|
| | Filler element solely | Monolithic | | Laminated | | Tempered | |
| | | 24-26 °C | 31-31 °C | 24-26 °C | 31-31 °C | 24-26 °C | 31-31 °C |
| 80 | 31 | 30 | 34 | 30 | 29 | 29 | 25 |
| 100 | 41 | 26 | 26 | 26 | 26 | 27 | 26 |
| 125 | 37 | 25 | 22 | 23 | 17 | 24 | 23 |
| 160 | 33 | 27 | 28 | 28 | 28 | 28 | 27 |
| 200 | 37 | 25 | 26 | 26 | 25 | 25 | 26 |
| 250 | 40 | 27 | 27 | 27 | 28 | 28 | 28 |
| 315 | 37 | 29 | 29 | 28 | 29 | 28 | 30 |
| 400 | 44 | 30 | 30 | 30 | 31 | 29 | 31 |
| 500 | 45 | 31 | 31 | 32 | 31 | 31 | 32 |
| 630 | 48 | 32 | 32 | 32 | 33 | 32 | 33 |
| 800 | 49 | 32 | 32 | 33 | 34 | 32 | 33 |
| 1000 | 51 | 34 | 34 | 34 | 36 | 33 | 33 |
| 1250 | 53 | 34 | 34 | 36 | 37 | 34 | 34 |
| 1600 | 54 | 31 | 31 | 34 | 36 | 32 | 32 |
| 2000 | 55 | 35 | 34 | 37 | 38 | 35 | 34 |
| 2500 | 53 | 38 | 37 | 40 | 41 | 37 | 37 |
| 3150 | 53 | 40 | 40 | 42 | 42 | 39 | 39 |
| 4000 | 55 | 41 | 42 | 44 | 44 | 41 | 40 |
| OITC (ASTM E1332-90) | 42 | 30 | 30 | 31 | 29 | 30 | 31 |

Acknowledgements

This study was fully funded by Ministry of Research, Technology and Higher Education Republic of Indonesia under the scheme of *Hibah Kompetensi* under the project "Acoustical Characteristic of Architectural Glass in Warm Humid Climate" with contract number 023.04.1.673453/2015 (made through *Kopertis Wilayah VII*).

References

- [1] JD Quirt, Sound transmission through windows I single and double glazing. J. Acoust. Soc. Am 72 (1982) 834-844
- [2] JD Quirt, Measurement of the sound transmission loss of windows. Building Research Note 72 (1981) 1-7
- [3] Garg N, Sharma O and Maji S. Experimental investigations on sound insulation through single, double & triple window glazing for traffic noise abatement. J Sci Ind Res 70 (2011) 471-478
- [4] ---, Outdoor-indoor transmission class of concrete masonry wall, Tek 13-4A, National concrete masonry association publication, Virginia, 2012, p.3
- [5] ---, Acoustical guide – principles of acoustics, available on https://www.saflex.com/saflex_acoustical_guide, accessed on Sep 21st, 2015
- [6] ---, Acoustic noise barrier wavebar, Pyrotek noise control, available on www.pyroteknc.com, accessed on Sep 21st, 2015
- [7] ---, Sound investment how the acoustical properties of building products are measured and why this is important, available on http://www.jeld-wenresearch.com/_pdfs/Sound_Investment.pdf, accessed on Sep 28th, 2015
- [8] ---, Noise Control, available on http://www.nationalglass.com.au/catalogues/NGP_Section_16.pdf, accessed on Sep 29th, 2015
- [9] ---, Sound Control for Fenestration Products TIR-A1-03 available on <http://stergis.com/sdb2/test?task=document.viewdoc&id=180>, accessed on Sep 30th, 2015
- [10] Benjamin H Sachwald, Christian P.H. Thompson, An examination of the OITC metric for building façade design in New York City, Noise-Con 2011, Portland, Oregon, 2011
- [11] Pettersson B, Indoor noise and high sound levels – a transcription of the Swedish National Board of health and welfare's guidelines, J. of Sound & Vibration 205:4 (1997) 475 - 480
- [12] Mediatika CE, Design solutions for naturally ventilated houses in hot humid region with reference to noise and particulate matter reduction, unpublished PhD dissertation, University of Strathclyde, Glasgow, UK, 2000
- [13] ---, Architectural Glass, Asahimas AGC Group Company Profile
- [14] ---, International Building Code, International Code Council, 2003, 2006, 2009, 2012, 2015
- [15] ---, Indonesia Building Regulation, 2002
- [16] ASTM E90-09. Standard test method for laboratory measurement of airborne sound transmission loss of building partitions and elements. American Society for Testing and Materials, West Conshohocken, PA, 19428-2959 USA, 2009.
- [17] R.A. McMaster, Fundamentals of tempered glass. Proc of 49th Conference on Glass Problems: Ceramic Engineering and Science Proceedings, Volume 10, John Wiley and Sons, 2009.
- [18] R. Persson, Flat Glass Technology, Springer Science+ Business Media New York, 1969.
- [19] Karyono T.H., Report on Thermal Comfort and Building Energy Studies in Jakarta, Indonesia. Building and Environment, 35 (2000) 77-90.

- [20] Feriadi H. & N.H. Wong, Thermal Comfort for Naturally Ventilated Houses in Indonesia. *Energy and Building*, 36 (2004) 614-626.
- [21] A.D. Hariyanto, Thermal comfort study of an air-conditioned design studio in tropical Surabaya. *Dimensi Teknik Arsitektur*, 33-1 (2005) 76-86
- [22] ---, *Tiga jenis kaca yang sering digunakan pada bangunan*, available on infoklasika.print.kompas.com/tiga-jenis-kaca-yang-sering-digunakan-pada-bangunan/ accessed on March 25th, 2015
- [23] ---, FGMA glassing manual, Kansas, USA, 1990
- [24] ---, Pilkington NSG glass manual, June 2014
- [25] P. Lord & D. Templeton, *Detailing for acoustic*, Taylor Francis, (1996) 103.
- [26] Noral Stewart, Outdoor to indoor A-weighted sound level reduction of typical modular classrooms and assessment of potential performance improvements based on the outdoor-indoor transmission class spectrum, Proc 156th Meeting Acoustical Society of America, Florida, 2008
- [27] ASTM E1332-90, Standard Classification for Determination of Outdoor-Indoor Transmission Class, American Society for Testing and Materials, West Conshohocken, PA, 19428-2959 USA, 1998, superseded by ASTM E1332-10a, Standard Classification for Rating Outdoor-Indoor Sound Attenuation, American Society for Testing and Materials, West Conshohocken, PA, 19428-2959 USA, 2010
- [28] ----, New windshield improves, vehicle interior cabin noise and articulation index, available on <https://www.saflex.com/pdf/Saflex%20AE%20Technical%20Paper%20-%20New%20Windshield%20Improves%20Acoustic%20Experience.pdf>, accessed on Oct 26th, 2015
- [29] Lasse Kinnari, Improving the sound insulation of construction boards with a high damping glue, Proc Inter Noise, Melbourne, 2014
- [30] Michael L Mackereth, Acoustical testing: facts and misconceptions, available on www.nwda.net/presentations/Acoustical%20Performance%20MLM%20Version.pdf, accessed on Sep 21st, 2015
- [31] CE Mediastika, et al, Sound transmission class (STC) of fixed window glazing in warm humid environment, Proc 7th International Conference on Environmental Science and Development (ICESD), Athens, 2015