

PAPER • OPEN ACCESS

## Application of Metaheuristic Algorithms in Truss Structure Sizing Optimization

To cite this article: D. Prayogo *et al* 2020 *IOP Conf. Ser.: Earth Environ. Sci.* **506** 012045

View the [article online](#) for updates and enhancements.

This site uses cookies. By continuing to use this site you agree to our use of cookies. To find out more, see our [Privacy and Cookies policy](#).



## Table of contents

Volume 506

2020

◀ Previous issue    Next issue ▶

**Joint International Conference on Civil, Environmental, and Geo Engineering 2019 1-2 October 2019, Surabaya, Indonesia**

Accepted papers received: 07 May 2020

Published online: 10 June 2020

Open all abstracts

### Preface

**OPEN ACCESS** 011001

Preface

+ Open abstract    View article    PDF

**OPEN ACCESS** 011002

Peer review statement

+ Open abstract    View article    PDF

### Environmental Engineering

**OPEN ACCESS** 012001

Evaluation of Step Feeding Strategy in One-Stage Simultaneous Partial Nitritation, Anammox and Denitrification (SPNAD) Process

L C Direstiyani, J Kim, T Kwon, S Jeong, Y Kim, J Yu and T Lee

+ Open abstract    View article    PDF

**OPEN ACCESS** 012002

A Comparative Study of Life Cycle Impact Assessment using Different Software Programs

A P Iswara, A U Farahdiba, E N Nadhifatin, F Pirade, G Andhikaputra, I Muflihah and R Boedisantoso

+ Open abstract    View article    PDF

**OPEN ACCESS** 012003

The treatment of Raw Water Sources of Drinking Water using Chitosan/Mg/Al-LDH Composites: Problem cases in Municipal Waterworks in Banjarmasin

C Irawan, M W Ramadhan, I F Nata and M D Putra

+ Open abstract    View article    PDF

**OPEN ACCESS** 012004

Formulation of Attributes for Decision Support System for Drinking Water Infrastructure Developments Priority

K A Putra and U Lasminto

+ Open abstract    View article    PDF

**OPEN ACCESS** 012005

Utilization of *Hermetia illucens* Larvae as A Bioconversion Agent to Reduce Organic Waste

N Fadhillah and A Y Bagastyo

+ Open abstract    View article    PDF

- 
- OPEN ACCESS** 012006  
Adsorption of Fe<sup>3+</sup> ion from Aqueous Solution onto Rice Husk Biocomposite Magnetic Nanoparticle  
I F Nata, A Mirwan, D R Wicakso, C Irawan, M D Isnaini and R Fitriani  
[+](#) Open abstract [View article](#) [PDF](#)
- 
- OPEN ACCESS** 012007  
The Azeotropic Distillation for Bioethanol Purification: The Effects of Entrainer Solvents  
T Sriana, S Sakti, T Dianpalupidewi and A Wahyudi  
[+](#) Open abstract [View article](#) [PDF](#)
- 
- OPEN ACCESS** 012008  
The Effort to Increase Waste Reduction Through the Development of Waste Banks in South Surabaya  
O M C Kesauliya and I D A A Warmadewanthi  
[+](#) Open abstract [View article](#) [PDF](#)
- 
- OPEN ACCESS** 012009  
Aluminum and Organic Contaminant Removal from Drinking Water Treatment Sludge  
R A Barakwan, A R Syavira and Y Trihadiningrum  
[+](#) Open abstract [View article](#) [PDF](#)
- 
- OPEN ACCESS** 012010  
Microhydro with Tube: A Powerhouse Solution for Rural Electricity  
Purwanto, Budiono, Hermawan and Sudarno  
[+](#) Open abstract [View article](#) [PDF](#)
- 
- OPEN ACCESS** 012011  
Toxicity Effects of Organic Substances on Nitrification Efficiency  
W N Rochmah and S Mangkoedihardjo  
[+](#) Open abstract [View article](#) [PDF](#)
- 
- OPEN ACCESS** 012012  
Wet Scrubber for Coal Combustion with The Use of Textile Wastewater Feeding  
HS Huboyo, Sudarno and LN Prassanty  
[+](#) Open abstract [View article](#) [PDF](#)
- 
- OPEN ACCESS** 012013  
The Effect of Mixing Rate on Struvite Recovery from The Fertilizer Industry  
Warmadewanthi, A Rodlia, N Ikhlas, E S Pandebesie, A Y Bagastyo and W Herumurti  
[+](#) Open abstract [View article](#) [PDF](#)
- 
- OPEN ACCESS** 012014  
Potential of Low Cost Sensor Usage for Waste Water IOT System  
A S Telaga, E A Goffar and W Sarfat  
[+](#) Open abstract [View article](#) [PDF](#)
- 
- OPEN ACCESS** 012015  
Effects of Organic Substance on Denitrification Efficiency  
S N Kholida and S Mangkoedihardjo  
[+](#) Open abstract [View article](#) [PDF](#)
- 
- OPEN ACCESS** 012016  
Effect of Rotation Speed on Phosphate and Nitrate Removal from Domestic Wastewater in The Oxidation Ditch  
E N Hidayah, A U Farahdiba, D W Zara and F Rosariawari  
[+](#) Open abstract [View article](#) [PDF](#)

<b>OPEN ACCESS</b> Study of Phasing Plan of Kalimati Water Treatment Plant Installation in Sidoarjo S Firdaus and A Purnomo <a href="#">+</a> Open abstract <a href="#">View article</a> <a href="#">PDF</a>	012017
<b>OPEN ACCESS</b> Evaluation of Zona Air Minum Prima (ZAMP) Program in Ngagel Tirto Surabaya D Erianik, B D Marsono and E S Soedjono <a href="#">+</a> Open abstract <a href="#">View article</a> <a href="#">PDF</a>	012018
<b>OPEN ACCESS</b> Planning of the Main Distribution Network of the Prambon Subdistrict Region in 2032 G N F Nugroho, A Purnomo, S Firdaus, B D Marsono and R Sumarsono <a href="#">+</a> Open abstract <a href="#">View article</a> <a href="#">PDF</a>	012019
<b>OPEN ACCESS</b> Impact of Additional Water Capacity from Umbulan Spring to Water Distribution System of Central Gresik and South Gresik R F A Tarigan and A Purnomo <a href="#">+</a> Open abstract <a href="#">View article</a> <a href="#">PDF</a>	012020
<b>OPEN ACCESS</b> Design of Sewerage System and Wastewater Treatment Plant in Asemrowo, Surabaya, Indonesia N L Rosari and I F Purwanti <a href="#">+</a> Open abstract <a href="#">View article</a> <a href="#">PDF</a>	012021
<b>OPEN ACCESS</b> Drinking Water Processing Using UV Rays S Purwoto, Rusdiyantoro, B P Sembodo and Y D Nurcahyanie <a href="#">+</a> Open abstract <a href="#">View article</a> <a href="#">PDF</a>	012022
<b>OPEN ACCESS</b> Impact Assessment of Coal Power Plant Using Life Cycle Assessment (LCA) B S S Wibawa, A P Iswara and R Boedisantoso <a href="#">+</a> Open abstract <a href="#">View article</a> <a href="#">PDF</a>	012023
<b>OPEN ACCESS</b> Environmental Impact Studied using Life Cycle Assessment on Cement Industry A Rosyid, R Boedisantoso and A P Iswara <a href="#">+</a> Open abstract <a href="#">View article</a> <a href="#">PDF</a>	012024
<b>OPEN ACCESS</b> Impacts Assessment of Crude Oil Exploration Using Life Cycle Assessment (LCA) S Sulistyawanti, A P Iswara and R Boedisantoso <a href="#">+</a> Open abstract <a href="#">View article</a> <a href="#">PDF</a>	012025
<b>OPEN ACCESS</b> Reduction of Organic Parameters in Apartment Wastewater using Sequencing Batch Reactor by adding Activated Carbon Powder F A Sekarani and N Hendrasarie <a href="#">+</a> Open abstract <a href="#">View article</a> <a href="#">PDF</a>	012026
<b>OPEN ACCESS</b> Design of Water Distribution by Using Umbulan Water in West Surabaya Y C Kurniawan, B D Marsono, E S Soedjono and A Yuniarto	012027

[+](#) Open abstract [View article](#) [PDF](#)

---

**OPEN ACCESS**

012028

A Study of Drinking Water Supply and Demand in Surabaya in the Year 2039

F F Pradypna, B D Marsono and E S Soedjono

[+](#) Open abstract [View article](#) [PDF](#)

---

**OPEN ACCESS**

012029

Evaluation and Design of Wastewater Management at Indrasari Rengat Hospital for Upgrade Program from Class C to B

F P Putra

[+](#) Open abstract [View article](#) [PDF](#)

---

**OPEN ACCESS**

012030

The Effect of Idle Capacity on The Treatment Efficiency of IPAL PT. X

N Karmaningroem and F R Shinta

[+](#) Open abstract [View article](#) [PDF](#)

---

**OPEN ACCESS**

012031

The Role of HACCP Method in Determining Drinking Water Quality

N Karmaningroem and M U L Sunaya

[+](#) Open abstract [View article](#) [PDF](#)

---

**OPEN ACCESS**

012032

Study of the Wastewater Treatment Plant at Industrial Estate Rungkut Surabaya (SIER), East Java, Indonesia

J P de Araujo and B V Tangahu

[+](#) Open abstract [View article](#) [PDF](#)

---

**OPEN ACCESS**

012033

Waste Transportation Route Optimization in Malang using Network Analysis

A.H Putra, A. Amalia, R.K.H Putro and L.F Darmayani

[+](#) Open abstract [View article](#) [PDF](#)

---

**OPEN ACCESS**

012034

Study of Leachate Penetration in Shallow Groundwater Around Jabon Landfill Sidoarjo

S M P Marendra and B V Tangahu

[+](#) Open abstract [View article](#) [PDF](#)

---

**OPEN ACCESS**

012035

Reducing Suspended Organics in Surface Water by Hydraulic Coagulation Processes in Parshall Flume

F. Rosariawari, A.U Farahdiba and P. Soedjarwo

[+](#) Open abstract [View article](#) [PDF](#)

---

**OPEN ACCESS**

012036

Rehabilitation Planning of Gedangkeret Landfill in Jombang Region

G R A Mujaddid and E S Pandebesie

[+](#) Open abstract [View article](#) [PDF](#)

---

**OPEN ACCESS**

012037

Analysis of The Increasing Need of Drinking Water as The Effect of High-rise Building Growth in Eastern Surabaya

A R Rihendyh, A Yuniarto and I Wahyuningsih

[+](#) Open abstract [View article](#) [PDF](#)

---

**OPEN ACCESS**

012038

Effect of Flow Rate on Electrochemical Oxidation of Landfill Leachate Using DSA and BDD Anode

E Nurhayati, A Y Bagastyo and D D Hartatik

[+](#) Open abstract [View article](#) [PDF](#)

## Civil Engineering

**OPEN ACCESS** 012039

Cost Overrun in Construction Projects in Indonesia

R Susanti and A Nurdiana

[+](#) Open abstract [View article](#) [PDF](#)

**OPEN ACCESS** 012040

Assessing Risk on The Engineering Procurement Construction (EPC) Project from The Perspective of The Owner: A Case Study

A Nurdiana and R Susanti

[+](#) Open abstract [View article](#) [PDF](#)

**OPEN ACCESS** 012041

Evaluation of Shear-Critical Reinforced Concrete Beam Blended with Fly Ash

M Mooy, A Tambusay, I Komara, W Sutrisno, Faimun and P Suprobo

[+](#) Open abstract [View article](#) [PDF](#)

**OPEN ACCESS** 012042

Flexural Behaviour of a Reinforced Concrete Beam Blended with Fly ash as Supplementary Material

W N Oktaviani, A Tambusay, I Komara, W Sutrisno, F Faimun and P Suprobo

[+](#) Open abstract [View article](#) [PDF](#)

**OPEN ACCESS** 012043

Effect of Chloride Ions on Concrete with Geopolymer Coatings in Coastal Area

S F Nastiti and J J Ekaputri

[+](#) Open abstract [View article](#) [PDF](#)

**OPEN ACCESS** 012044

Enhancing the Ductility of a Reinforced Concrete Beam using Engineered Cementitious Composite

M A Bastian, A Tambusay, I Komara, W Sutrisno, D Irawan and P. Suprobo

[+](#) Open abstract [View article](#) [PDF](#)

**OPEN ACCESS** 012045

Application of Metaheuristic Algorithms in Truss Structure Sizing Optimization

D. Prayogo, K. Harsono, K. E. Prasetyo, F. T. Wong and D. Tjandra

[+](#) Open abstract [View article](#) [PDF](#)

**OPEN ACCESS** 012046

The Effect of Adding Minerals on Plastic Aggregate to Lightweight Concrete

K A Wiswamitra, S M Dewi, M A Choiron and A Wibowo

[+](#) Open abstract [View article](#) [PDF](#)

**OPEN ACCESS** 012047

Reliability-based Design with Size and Shape Optimization of Truss Structure Using Symbiotic Organisms Search

D. Prayogo, G. Gaby, B. H. Wijaya and F.T. Wong

[+](#) Open abstract [View article](#) [PDF](#)

**OPEN ACCESS** 012048

Structural Design Optimization Using Particle Swarm Optimization and Its Variants

D. Prayogo, Sebastian, W. Hauwing, F.T. Wong and D. Tjandra

[+](#) Open abstract [View article](#) [PDF](#)

- 
- OPEN ACCESS** 012049  
The Empirical Prediction of The Critical Area of Road Embankment Landslide Using Limit Equilibrium Method  
P T K Sari and Y Lastiasih  
[+](#) Open abstract [View article](#) [PDF](#)
- 
- OPEN ACCESS** 012050  
Mapping of Sea Surface Temperature and its Correlation with Salinity Concentration in The Coastal Beach of Bangkalan Madura District  
S Zainab, N Handajani and H Wibisana  
[+](#) Open abstract [View article](#) [PDF](#)

---

## Geophysical Engineering

- 
- OPEN ACCESS** 012051  
Estimation of Shear Wave Velocity Using Horizontal to Vertical Spectrum Ratio (HVSR) Inversion to Identify Faults in Pacitan  
A Haryono, Sungkono, M A Caesardi, B J Santosa, F Syaifuddin and A Widodo  
[+](#) Open abstract [View article](#) [PDF](#)
- 
- OPEN ACCESS** 012052  
Groundwater Hydrogeochemistry in Bukit Raya and Tenayan Raya, Pekanbaru, Indonesia  
F Rafi, M Karuniasa and A Assegaf  
[+](#) Open abstract [View article](#) [PDF](#)
- 
- OPEN ACCESS** 012053  
Seismic Site Effect Mapping Based on Natural Frequency Using Microtremor Method in Sidoarjo District  
A Widodo, J P G N Rochman, A Perdana and F Syaifuddin  
[+](#) Open abstract [View article](#) [PDF](#)
- 
- OPEN ACCESS** 012054  
Active Fault Delineation Using Magnetotelluric Data in The Western Region of East Java  
W Lestari, A Widodo, D D Warnana, F Syaifuddin, J P G N Rochman, A Zarkasyi and N S Setiawan  
[+](#) Open abstract [View article](#) [PDF](#)

---

## JOURNAL LINKS

---

[Journal home](#)

---

[Information for organizers](#)

---

[Information for authors](#)

---

[Search for published proceedings](#)

---

[Contact us](#)

---

[Reprint services from Curran Associates](#)

[i](#) [x](#)

## Open Access

**Submit Your Research**

The official journal of the European Society for Paediatric Endocrinology

karger.com

# IOP Conference Series: Earth and Environmental Science

COUNTRY	SUBJECT AREA AND CATEGORY	PUBLISHER	H-INDEX
<p>United Kingdom</p>  <p>Universities and research institutions in United Kingdom</p>	<p>Earth and Planetary Sciences Earth and Planetary Sciences (miscellaneous)</p> <p>Environmental Science Environmental Science (miscellaneous)</p>	<p>IOP Publishing Ltd.</p>	<h1>26</h1>



PUBLICATION TYPE	ISSN	COVERAGE	INFORMATION
Conferences and Proceedings	17551307, 17551315	2010-2020	<p><a href="#">Homepage</a></p> <p><a href="#">How to publish in this journal</a></p> <p><a href="mailto:ees@iopublishing.org">ees@iopublishing.org</a></p>





## SCOPE

The open access IOP Conference Series: Earth and Environmental Science (EES) provides a fast, versatile and cost-effective proceedings publication service.

[Join the conversation about this journal](#)

## Submit Your Manuscript With Us

Our Journals are Peer-Reviewed & Open Access. Publish With Us & Reach a Wider Audience.

Hindawi

SJR

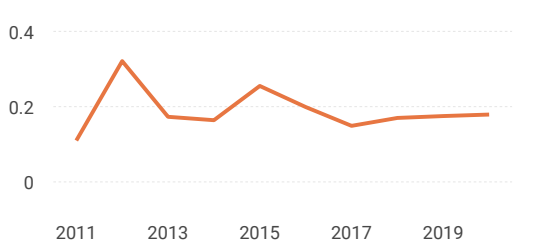

Total Documents

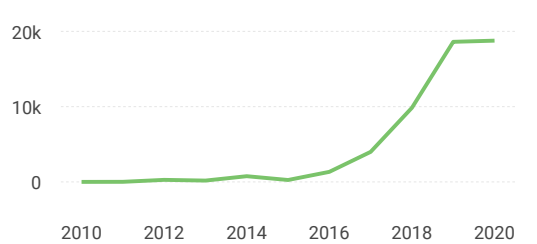

Total Cites    Self-Cites

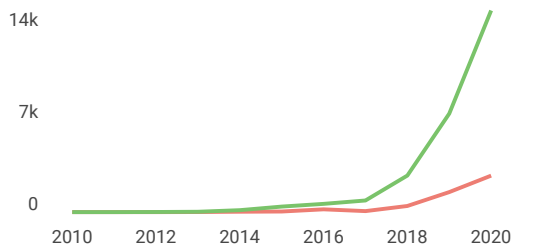

Citations per document

External Cites per Doc    Cites per Doc



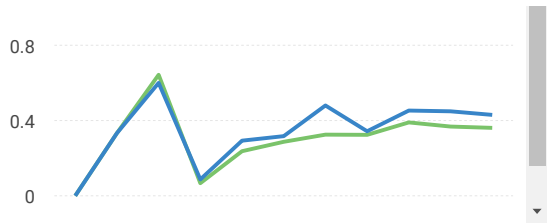

% International Collaboration

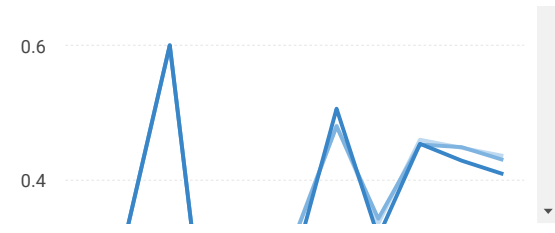

Citable documents Non-citable documents

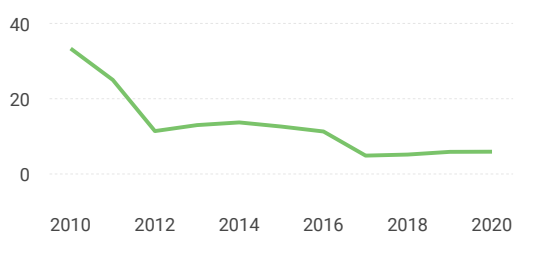

Cited documents Uncited documents

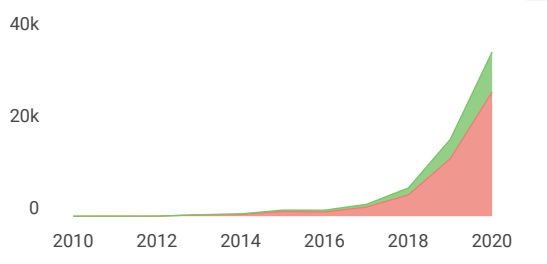
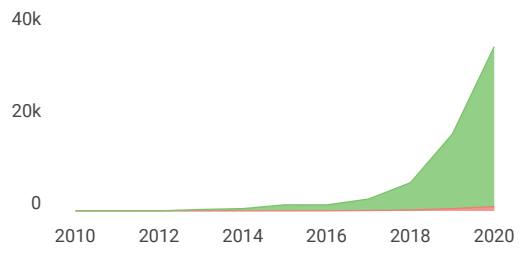

**IOP Conference Series: Earth and Environmental...**

Not yet assigned quartile

**SJR 2020**  
0.18

powered by scimagojr.com

← Show this widget in your own website

Just copy the code below and paste within your html code:

```
<a href="https://www.scimagojr.com" style="color: #0070C0; text-decoration: none;">

```

**SCImago Graphica**

Explore, visually communicate and make sense of data with our **new free tool**.



Get it

## Submit Your Manuscript With Us

Our Journals are Peer-Reviewed & Open Access. Publish With Us & Reach a Wider Audience.

Hindawi

Metrics based on Scopus® data as of April 2021

reply



**Melanie Ortiz** 7 months ago

SCImago Team

Dear Alharia,  
thank you very much for your comment, unfortunately we cannot help you with your request. We suggest you contact Scopus support:  
[https://service.elsevier.com/app/answers/detail/a\\_id/14883/kw/scimago/supporthub/scopus/](https://service.elsevier.com/app/answers/detail/a_id/14883/kw/scimago/supporthub/scopus/)  
Best Regards, SCImago Team

V **Vani** 7 months ago

good evening, whether this journal is Q4 or Q2 ?

reply



**Melanie Ortiz** 7 months ago

SCImago Team

Dear Vani,  
Thank you for contacting us.  
As said below, we calculate the SJR data for all the publication's types, but the Quartile's data are only calculated for Journals and Book Series.  
Best regards, SCImago Team

F **FEROSKHAN M** 1 year ago

IOP Conference Series: Earth and Environmental Science - Volume 573 is not available in Scopus. But later volumes are available. May I know when will they publish in Scopus?

reply



**Melanie Ortiz** 1 year ago

SCImago Team

Dear Sir/Madam,  
thank you very much for your comment, unfortunately we cannot help you with your request. We suggest you contact Scopus support:  
[https://service.elsevier.com/app/answers/detail/a\\_id/14883/kw/scimago/supporthub/scopus/](https://service.elsevier.com/app/answers/detail/a_id/14883/kw/scimago/supporthub/scopus/)  
Best Regards, SCImago Team

N **Natt** 1 year ago

I would like to know the quartile of this journal. Why isn't it showing on the website?

reply



**Melanie Ortiz** 1 year ago

Dear Natt,  
Thank you for contacting us. We calculate the SJR data for all the publication's types, but the Quartile's data are only calculated for Journals and Book Series.  
Best regards, SCImago Team

**N** **Nurgustaana** 2 years ago

Dear SCImago Team!  
I want to know previous quartiles of journal (for 2018 and 2019 years). I have tried find information about a quartile, but discovered just SJR for 2018. Could you please provide information about it?  
Yours sincerely, Nurgustaana

reply



**Melanie Ortiz** 2 years ago

Dear Nurgustaana,  
Thank you for contacting us. We calculate the SJR data for all the publication types, but the Quartile data are only calculated for Journal type's publications. Best regards,  
SCImago Team

**M** **Mora** 2 years ago

hello, how to search one of journal who publised by IOP, because when i find it by the title, they are not able in scimagojr but the publisher is available in here, thank you for the respond it means a lot

reply



**Melanie Ortiz** 2 years ago

Dear Mora,  
  
thank you for contacting us. Could you provide us the Title of the journal? We remember that SCImago Journal & Country Rank shows all the information have been provided by Scopus. If you didn't localize the journal in the search engine, it means that Scopus / Elsevier has not provided us the corresponding data.

Best Regards, SCImago Team

**D** **Dr. Yousif** 2 years ago

Dear Sir,

I have published a paper in Earth and Environmental Science Journal (only myself, single author) I am trying to withdraw it after 28 days of publishing online, is it possible? Could you please tell me

the procedure of withdrawing a paper?

Thank you,

reply



**Melanie Ortiz** 2 years ago

SCImago Team

Dear Yousif,

thank you for contacting us.

We are sorry to tell you that SCImago Journal & Country Rank is not a journal. SJR is a portal with scientometric indicators of journals indexed in Elsevier/Scopus.

Unfortunately, we cannot help you with your request, we suggest you to contact the journal's editorial staff , so they could inform you more deeply. Best Regards, SCImago Team

A **Agustinus Kastanya** 2 years ago

need information about renking of the Journal on Scopus

reply



**Melanie Ortiz** 2 years ago

SCImago Team

Dear Agustinus, thank you very much for your comment, unfortunately we cannot help you with your request. We suggest you to consult the Scopus database directly. Remember that the SJR is a static image of a database (Scopus) which is changing every day. Best regards, SCImago Team

M **Mahipal** 2 years ago

Dear Admin,

How could our journal include in your IOP?

reply



**Melanie Ortiz** 2 years ago

SCImago Team

Dear Mahipal,

thank you for contacting us.

We suggest you to contact the IOP's editorial staff , so they could inform you more deeply.

If you would like to make an application to Scopus, please contact them to help you with this issue here: <https://www.elsevier.com/solutions/scopus/content/content-policy-and-selection>

<http://suggestor.step.scopus.com/suggestTitle/step1.cfm>

Best Regards, SCImago Team

M **Mursalin** 2 years ago

Dear SCImago Team

My name is mursalin from Jambi City, Indonesia. I have published my article titled The Effect of Temperature on MDAG Purification Using Creaming Demulsification Technique at the IOP Conference Series: Earth and Environmental Science, Volume 309, conference 1 and could be accessed at: <https://iopscience.iop.org/article/10.1088/1755-1315/309/1/012068>. But why until now it does not appear into Google Scholar and my account.

Please help me to resolve the issue. Thank you for your kindness. I am waiting for good news from you.

Sincerelly,  
Mursalin

reply



**Melanie Ortiz** 2 years ago

SCImago Team

Dear Mursalin,

Thank you for contacting us. Unfortunately, we can not help you with your request. Maybe other users can help you. Best Regards, SCImago Team

N **Танзиля Созаева** 2 years ago

Доброго времени суток! Интересует информация по квартилю журнала (издания)

reply



**Melanie Ortiz** 2 years ago

SCImago Team

Dear user, thank you very much for your request. You can consult that information in SJR website. Best Regards, SCImago Team

S **syaiful** 3 years ago

I am very interested to send my paper to this conference

best regards

syaiful

reply



**Elena Corera** 3 years ago

SCImago Team

Dear user, in the link below you will find the information corresponding to the author's instructions of this journal. Best regards, SCImago Team  
<https://publishingsupport.iopscience.iop.org/author-guidelines-for-conference-proceedings/>

### Leave a comment

Name

Email

(will not be published)

 I'm not a robot reCAPTCHA  
Privacy - Terms

Submit

The users of Scimago Journal & Country Rank have the possibility to dialogue through comments linked to a specific journal. The purpose is to have a forum in which general doubts about the processes of publication in the journal, experiences and other issues derived from the publication of papers are resolved. For topics on particular articles, maintain the dialogue through the usual channels with your editor.

Developed by:



Powered by:



Follow us on @ScimagoJR

Scimago Lab, Copyright 2007-2020. Data Source: Scopus®





# Application of Metaheuristic Algorithms in Truss Structure Sizing Optimization

D. Prayogo<sup>1\*</sup>, K. Harsono<sup>1\*</sup>, K. E. Prasetyo<sup>1</sup>, F. T. Wong<sup>1</sup>, D. Tjandra<sup>1</sup>

<sup>1</sup>Department of Civil Engineering, Petra Christian University, Jalan Siwalankerto 121-131, Surabaya 60236, Indonesia

\*Corresponding author e-mail: prayogo@petra.ac.id; m21416123@john.petra.ac.id

**Abstract.** Field studies of structural optimization have gained increased attention due to the rapid development of metaheuristic algorithms. One widely known metaheuristic algorithm, Particle Swarm Optimization (PSO), has been extensively used to solve many problems and is reported to have fast convergence behavior and good accuracy. As many problems become more complex, studies have been focused on improving PSO searching capability. This study presents the application of PSO and its variants in optimizing truss structures. The performances of PSO and several PSO variants, namely, linearly decreasing inertia weight PSO (LDW-PSO) and bare bones PSO (BB-PSO), were compared and investigated. All optimization algorithms were tested in 72-bar and 25-bar spatial truss problems. The results indicate that BBPSO was the best algorithm in terms of optimum solution, consistency, and convergence behavior.

## 1. Introduction

The truss structure is the most common structural component used in buildings. Steel truss structures are usually used as bracing or the main building structure. With rapid construction growth, finding more efficient structural designs through optimization are needed to minimize cost. The goal of structure optimization is to find the most efficiently sized structure without violating any engineering constraints. Structural efficiency is usually regarded as the weight of the structure [1].

Truss structure optimization has attracted recent and growing interest. Truss structures have many constraints and variables, which makes optimizing these structures complex and challenging. However, metaheuristic methods are efficient and effective in solving such large and complex problems [2]. Metaheuristic algorithms apply natural phenomena and randomization concepts to search for an optimum solution globally using trial and error [3]. Particle swarm optimization (PSO) [4] is a metaheuristic algorithm that is frequently used to solve optimization problem. PSO has a simple concept that mimics flocking birds. Despite its simplicity, PSO has some weaknesses, with one being parameters that can affect its performance. These parameters must be manually adjusted to the problem [5]. Several variants of PSO have been developed to overcome these weaknesses such as Linearly Decreasing Inertia Weight Particles Swarm Optimization (LDW-PSO) [6] and Bare Bones Particles Swarm Optimization (BBPSO) [7].



## 2. Particle swarm optimization (PSO)

### 2.1. Particle swarm optimization (PSO)

PSO mimics the behavior of flocking birds. In a manner similar to a flock of birds looking for food, the PSO searches for the optimal solution. This simple and easy to understand concept makes this algorithm popular with researchers. The weakness of this algorithm is the need to pre-set the parameters to adapt to different problems [7].

First, particle location is generated randomly in a specified range [6]. Then, each iteration particle moves to a new location using the velocity in Equation (1) and then updates its position using Equation (2). This new velocity is influenced by four factors: its initial velocity ( $v_i(t)$ ); the best location that this particle discovers ( $X_{pbest}(t)$ ); the best location from population ( $X_{gbest}(t)$ ); and its current location ( $X_i(t)$ ):

$$X_i(t+1) = X_i(t) + v_i(t+1), \quad (1)$$

$$v_i(t+1) = wv_i(t) + r_1 C_1 (X_{pbest}(t) - X_i(t)) + r_2 C_2 (X_{gbest}(t) - X_i(t)), \quad (2)$$

where  $v_i(t+1)$  is the next velocity;  $w$  is inertia weight;  $v_i(t)$  is the initial velocity;  $r_1$  and  $r_2$  are random numbers between 0 and 1;  $C_1$  and  $C_2$  are constants that have been set (usually 2);  $X_{pbest}(t)$  is personal best;  $X_i(t)$  is the initial location;  $X_{gbest}(t)$  is global best; and  $X_i(t+1)$  is the particle's new location.

### 2.2. Linearly decreasing inertia weight particles swarm optimization (LDW-PSO)

In PSO, inertia weight is used to balance the global and local searches. A large inertia weight represents a global search while a small inertia weight represents a local search. By linearly decreasing the inertia weight, PSO should have more global search ability at the beginning of the iteration while having more local search ability near the end of the iteration [6]. The inertia weight updates with Equation (3):

$$w = w - (w_s - w_e)(t) / (t_{max}), \quad (3)$$

where  $w$  is inertia weight;  $w_s$  is initial inertia weight;  $w_e$  is final inertia weight;  $t$  is current iteration; and  $t_{max}$  is total iteration.

### 2.3. Bare Bones Particle Swarm Optimization (BBPSO)

While LDW-PSO perfected the parameter in PSO, BBPSO eliminates all parameters. Instead of using velocity to update the location, BBPSO uses a Gaussian distribution. The particle's next position is only calculated by its personal best position and swarm global best position. Parameter-free means the algorithm can easily adapt to different problems [7]:

$$\begin{aligned} \mu &= \frac{pi + gbest}{2}, \\ \sigma &= |pi - gbest| \end{aligned} \quad (4)$$

$$x(i+1) = \begin{cases} N(\mu, \sigma) & \text{if } (\omega > 0.5) \\ pi & \text{else} \end{cases},$$

where  $P = (p_1, p_2, \dots, p_n)$  is the personal best position of each particle,  $gbest$  is the best position of the whole swarm, and  $\omega$  is a random number from 0 to 1.

**3. Materials and methods**

A combination of direct stiffness method (DSM) and metaheuristics were used for this truss optimization. Metaheuristics were used to find the optimal cross-sectional area while DSM was used to analyze the structure. DSM outputs are the displacement, axial force, and stress of each element. These outputs are used as constraints for this optimization. When a solution violates the constraints, a penalty is given to the solution.

Before conducting the research, researchers prepared a DSM program for a planar and spatial truss, and prepared three metaheuristic algorithms: PSO, LDW-PSO, and BBPSO. The DSM and metaheuristic algorithms were written using MATLAB 2017a and the results of the three algorithms were compared to determine the best performing algorithm. In general, this program randomizes the cross-section area, and iterates using trial and error until it reaches its maximum iteration. A flow chart of the truss optimization process is diagrammed in Figure 1.

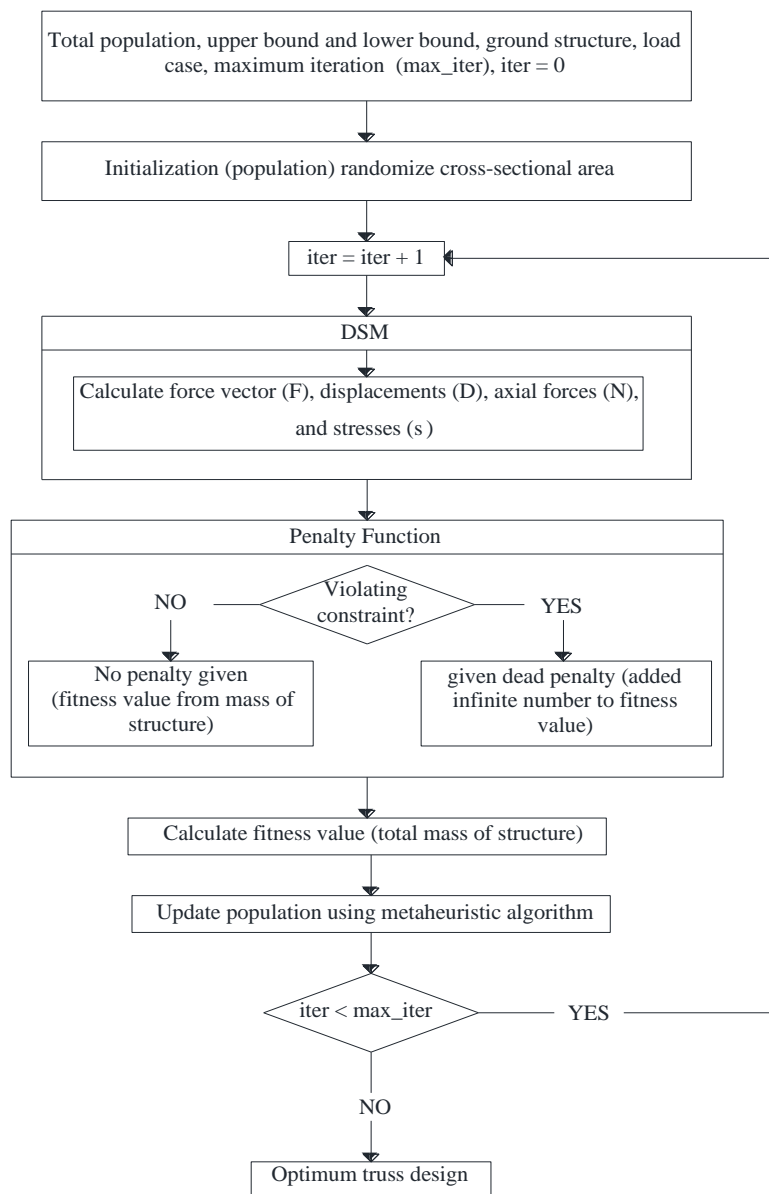

**Figure 1.** Truss optimization process flow chart

#### 4. Test problem and results

This paper compares the performance of three PSOs using a spatial 25-bar structure problem. Each structure had a load case and discrete variable, which are described next. The goal is to minimize the weight of the structure while not violating the constraints. Each algorithm was run 30 times and with 50 populations. The structures were analyzed using DSM. Algorithms and structural analyses were coded in MATLAB 2017a. Cognitive ( $C_1$ ) and social ( $C_2$ ) parameters for PSO and LPSO were set to 2. Inertia weight ( $W$ ) for PSO was set to 0.8 while the LPSO's inertia weight was linearly decreased from 0.9 to 0.1 with respect to iterations.

##### 4.1. Spatial 25-bar truss structure

The structure model presented in Figure 2 has been previously studied [3][8]. The material density is  $0.1 \text{ lb/in}^3$  and elastic modulus 10 Msi. The boundary conditions are stress and displacement. Stress limits in tension/compression is 40,000 psi and maximum nodal displacement for all free nodes in X, Y, and Z directions is  $\pm 0.35 \text{ in}$ . Members of the structure are grouped into eight groups: (1) A1; (2) A2–A5; (3) A6–A9; (4) A10–A11; (5) A12–A13; (6) A14–A17; (7) A18–A21; and (8) A22–25.

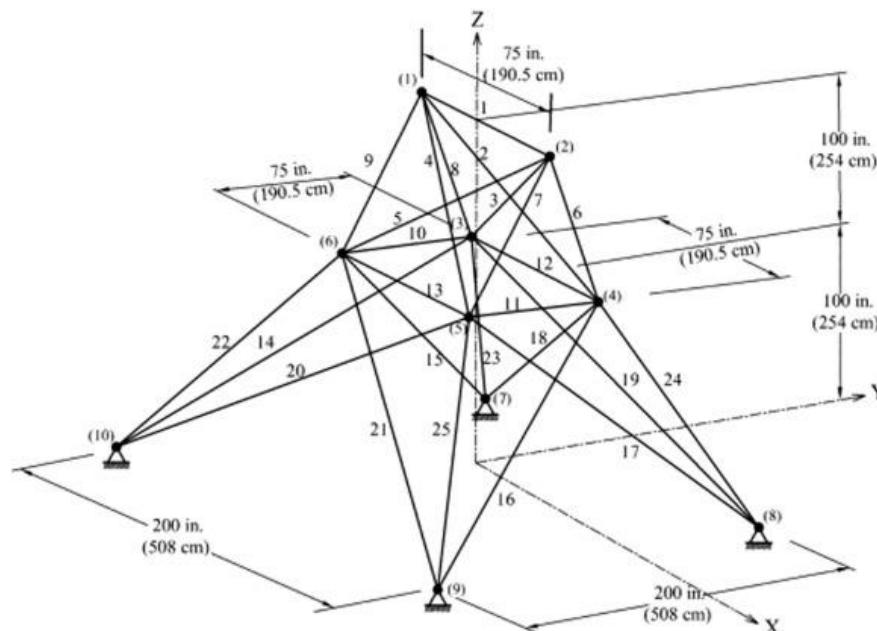

**Figure 2.** Spatial 25-bar truss structure model

There are two cases for this structure:

Case 1. The cross-sectional areas available are  $D = [0.1 \ 0.2 \ 0.3 \ 0.4 \ 0.5 \ 0.6 \ 0.7 \ 0.8 \ 0.9 \ 1.0 \ 1.1 \ 1.2 \ 1.3 \ 1.4 \ 1.5 \ 1.6 \ 1.7 \ 1.8 \ 1.9 \ 2.0 \ 2.1 \ 2.2 \ 2.3 \ 2.4 \ 2.5 \ 2.6 \ 2.7 \ 2.8 \ 2.9 \ 3.0 \ 3.1 \ 3.2 \ 3.3 \ 3.4 \ 3.5 \ 3.6]$  ( $\text{in}^2$ ). (Loads are shown in Table 1.)

Case 2. The cross-sectional areas available are  $D = [0.01 \ 0.4 \ 0.8 \ 1.2 \ 1.6 \ 2.0 \ 2.4 \ 2.8 \ 3.2 \ 3.6 \ 4.0 \ 4.4 \ 4.8 \ 5.2 \ 5.6 \ 6.0]$  ( $\text{in}^2$ ). (Loads are shown in Table 2.) In this case, there are two cases to be run and the cross-section used has to satisfy all boundary conditions in both cases.

**Table 1.** Loading Conditions for 25-bar Truss Problem (Case 1)

Load Cases	Nodes	Loads			
		$P_x$ (kips)	$P_y$ (kips)	$P_z$ (kips)	
Case 1	1	1	1	-10	-10
		2	0	-10	-10
		3	0.5	0	0
		6	0.6	0	0

**Table 2.** Loading Conditions for 25-bar Truss Problem (Case 2)

Load Cases	Nodes	Loads			
		$P_x$ (kips)	$P_y$ (kips)	$P_z$ (kips)	
Case 2	2	1	0	20	-5
		2	0	-20	-5
	3	1	1	10	-5
		2	0	10	-5
		3	0.5	0	0
		6	0.5	0	0

**Table 3.** Comparison Optimization Result for 25-bar Problem (Case 1)

Variables	HS[8]	PSO	LDW-PSO	BBPSO
A1	0.1	0.1	0.1	0.1
A2-A5	0.3	0.3	0.3	0.3
A6-A9	3.4	3.4	3.4	3.4
A10-A11	0.1	0.1	0.1	0.1
A12-A13	2.1	2.1	2.1	2.1
A14-A17	1	1	1	1
A18-A21	0.5	0.5	0.5	0.5
A22-A25	3.4	3.4	3.4	3.4
Best (lb)	484.85	484.85	484.85	484.85
Average (lb)	N/A	488.45596	487.0637	485.7423
Stdev (lb)	N/A	8.5055357	3.052439	1.013263
No. of analyses	13523	5000	5000	5000
Constraint violations	None	None	None	None

**Table 4.** Comparison Optimization Result for 25-bar Problem (Case 2)

Variables	HS[8]	PSO	LDW-PSO	BBPSO
A1	0.01	0.01	0.01	0.01
A2-A5	2	2	2	2
A6-A9	3.6	3.6	3.6	3.6
A10-A11	0.01	0.01	0.01	0.01
A12-A13	0.01	0.01	0.01	0.01
A14-A17	0.8	0.8	0.8	0.8
A18-A21	1.6	1.6	1.6	1.6
A22-A25	2.4	2.4	2.4	2.4
Best (lb)	560.59	560.59	560.59	560.59
Average (lb)	N/A	567.7245	577.5186	561.1604
Stdev (lb)	N/A	11.67591	21.0032	1.475004
No. of analyses	7435	5000	5000	5000
Constraint violations	None	None	None	None

A comparison among the three algorithms is shown in Table 4 for Case 1 and in Table 5 for Case 2. As can be seen, there were no constraint violations for any of the algorithms. All algorithms obtained the same minimum weight (484.85 lb for Case 1 and 560.59 lb for Case 2). The BBPSO algorithm was the best PSO algorithm in terms of consistency. Figures 3 and 4 show that BBPSO demonstrated better convergence behavior. From a previous study, harmony search (HS) [8] obtained the same best results for Case 1 and Case 2 with PSO variants used in this study. However, to achieve this result, HS needed a greater number of analyses than BBPSO.

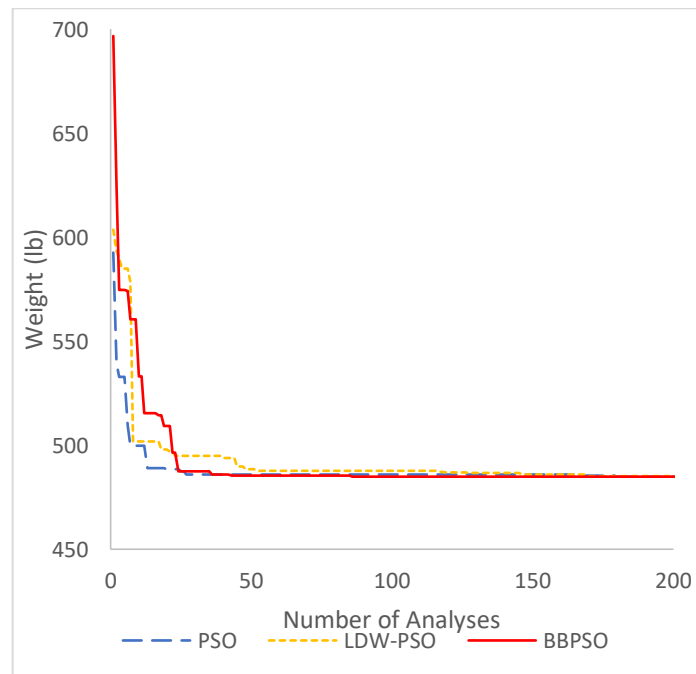
**Figure 3.** Convergence curves for 25-bar problem (case 1)

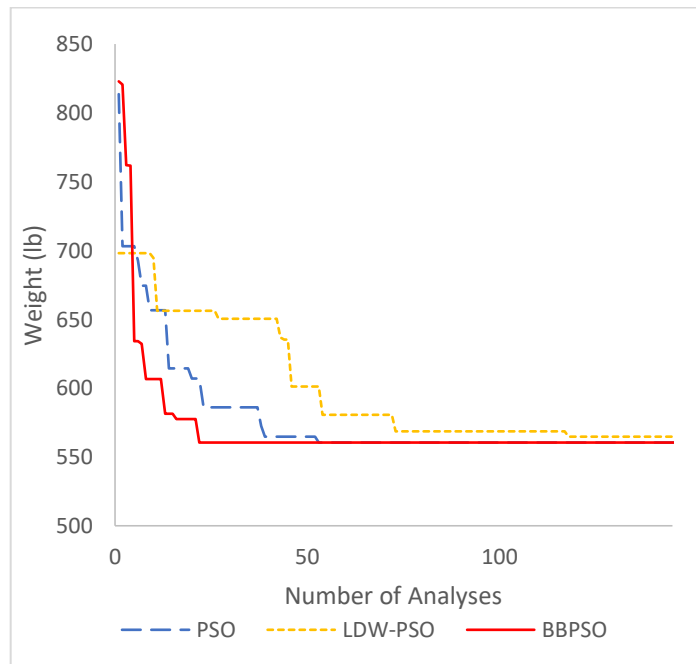

**Figure 4.** Convergence curves for 25-bar problem (case 2)

4.2. Spatial 72-bar truss structure

The 72-bar structure has 20 nodes and 60 degrees of freedom in X, Y, and Z directions. It comprises four identical floors as shown in Figure 5. The material density is 0.1 lb/in<sup>3</sup> and elastic modulus 10 Msi. The stress limit for compression/tension is 25,000 psi and displacement should not be more than ±0.35 in. Each story has a different cross-section for its vertical, horizontal, wall-bracing, and floor-bracing trusses. In total, there are 16 groups: (1) A1–A4; (2) A5–A12; (3) A13–A16; (4) A17–A18; (5) A19–A22; (6) A23–A30; (7) A31–A34; (8) A35–A36; (9) A37–A40; (10) A41–A48; (11) A49–A52; (12) A53–A54; (13) A55–A58; (14) A59–A66; (15) A67–A70; and (16) A71–A72. As in load Case 2 in the 25-bar truss structure, the 72-bar truss structure was subjected to two load cases as described in Table 5.

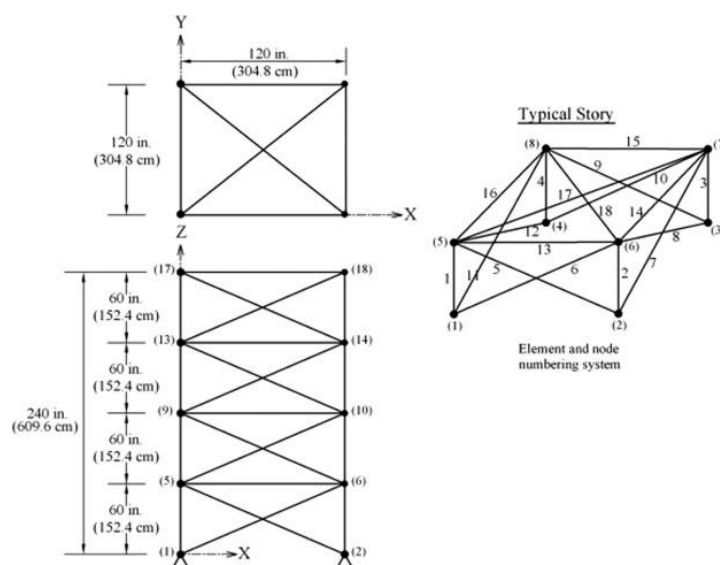

**Figure 5.** Spatial 72-bar truss structure model

**Table 5.** Comparison Optimization Result for 72-bar Problem

	Load Cases	Nodes	Loads		
			$P_x$ (kips)	$P_y$ (kips)	$P_z$ (kips)
Case 1	1	17	5	5	-5
		18	0	0	0
		19	0	0	0
		20	0	0	0
	2	17	0	0	-5
		18	0	0	-5
		19	0	0	-5
		20	0	0	-5

**Table 6.** Comparison of Optimization Result for 72-bar Problem

Variables	HS[8]	PSO	LDW-PSO	BBPSO
A1-A4	1.9	2	1.9	1.9
A5-A12	0.5	0.5	0.5	0.5
A13-A16	0.1	0.1	0.1	0.1
A17-A18	0.1	0.1	0.1	0.1
A19-A22	1.4	1.5	1.4	1.4
A23-A30	0.6	0.5	0.5	0.5
A31-A34	0.1	0.1	0.1	0.1
A35-A36	0.1	0.1	0.1	0.1
A37-A40	0.6	0.6	0.5	0.5
A41-A48	0.5	0.5	0.5	0.5
A49-A52	0.1	0.1	0.1	0.1
A53-A54	0.1	0.1	0.1	0.1
A55-A58	0.2	0.2	0.2	0.2
A59-A66	0.5	0.5	0.6	0.6
A67-A70	0.3	0.5	0.4	0.4
A71-A72	0.7	0.6	0.6	0.6
Best	387.94	412.08	403.75	385.54
Average	N/A	456.6132	490.91	390.7881
Stdev	N/A	46.22298	64.38027	3.742455
No. of analyses	16044	5000	5000	5000
Constraint violations	None	None	None	None

Table 6 shows that BBPSO had the best performance and the smallest standard deviation. Each algorithm ran 50,000 structural analyses. The PSO, LDW-PSO, and BBPSO obtained minimum weights of 386.81 lb, 385.54 lb, and 385.54 lb, respectively. However, LDW-PSO had 2.1% less weight than PSO while LPSO had a larger standard deviation, showing less consistency. In terms of consistency, BBPSO had the best convergence behavior as shown in Figure 6. In this case study, HS[8] was outperformed by BBPSO even though HS had a greater number of analyses.



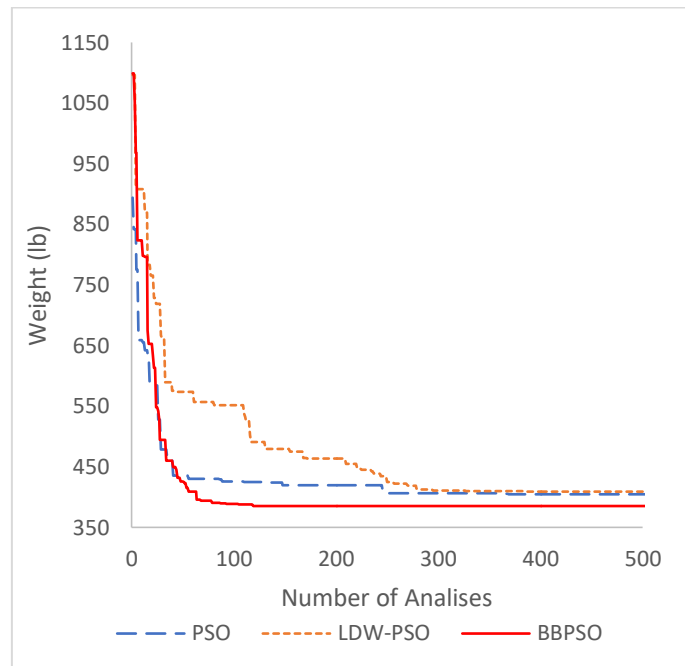

**Figure 6.** Convergence curves for 72-bar problem

## 5. Conclusion

This paper tested the variance in results of three PSO algorithms: BBPSO, LDW-PSO, and original PSO. The algorithms were presented with spatial truss problems coded using direct stiffness method. The results show BBPSO to be the best algorithm of the three tested algorithms. BBPSO had exceptional performance in terms of result, consistency, and convergence behavior. This is due to BBPSO having no pre-set parameters, which means that it is more adaptable to problems, whereas PSO and LDW-PSO contain pre-set variables. LPSO returned better results than the original PSO; however, LDW-PSO tends to have poorer convergence behavior. LDW-PSO performed more focused searches at the end of iteration due to its decreasing inertia weight, whereas PSO had the same coverage through each iteration. However, this could be a problem for convergence behavior because decreasing through the iteration means that LDW-PSO needs all iterations to find the optimum solution.

## References

- [1] Tang, W., Tong, L., and Gu, Y. 2005 Improved genetic algorithm for design optimization of truss structures with sizing, shape and topology variables. *International Journal for Numerical Methods in Engineering* **62** 13 pp 1737–1762 DOI:10.1002/nme.1244
- [2] Talbi, E.-G. 2009 *Metaheuristics: from design to implementation* (John Wiley & Sons)
- [3] Cheng, M., Prayogo, D., Wu, Y., and Lukito, M. M. 2016 A Hybrid Harmony Search algorithm for discrete sizing optimization of truss structure. *Automation in Construction* **69** pp 21-33 DOI:10.1016/j.autcon.2016.05.023
- [4] Eberhart, R., and Kennedy, J. 1995 A new optimizer using particle swarm theory *MHS95 Proceedings of the Sixth International Symposium on Micro Machine and Human Science* DOI:10.1109/mhs.1995.494215
- [5] X. Zhao, H. Liu, D. Liu, W. Ai and X. Zuo 2016 *New Modified Bare-bones Particle Swarm Optimization* pp 416-422
- [6] J.Xin, G. Chen and Y. Hai 2009 A particle swarm optimizer with multi-stage linearly-decreasing inertia weight *Proceedings of the 2009 International Joint Conference on Computational Sciences and Optimization, CSO 2009* **1** pp 505-508

- [7] J.Guo and Y. Sato 2017 A Pair-wise Bare Bones Particle Swarm Optimization Algorithm for Nonlinear Functions, *International Journal of Networked and Distributed Computing* **5** 3 p 143
- [8] Lee, K. S., Geem, Z. W., Lee, S., & Bae, K. 2005 The harmony search heuristic algorithm for discrete structural optimization *Engineering Optimization* **37** 7 pp 663–684 DOI:10.1080/03052150500211895